

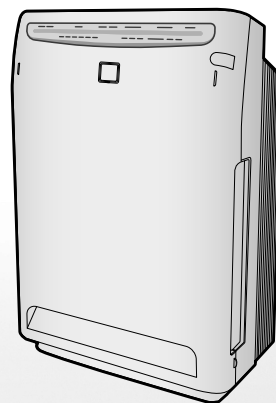

# Air Purifier

## OPERATION MANUAL

Floor Standing, Wall-hanging Type



**MODEL**

MC70LVM

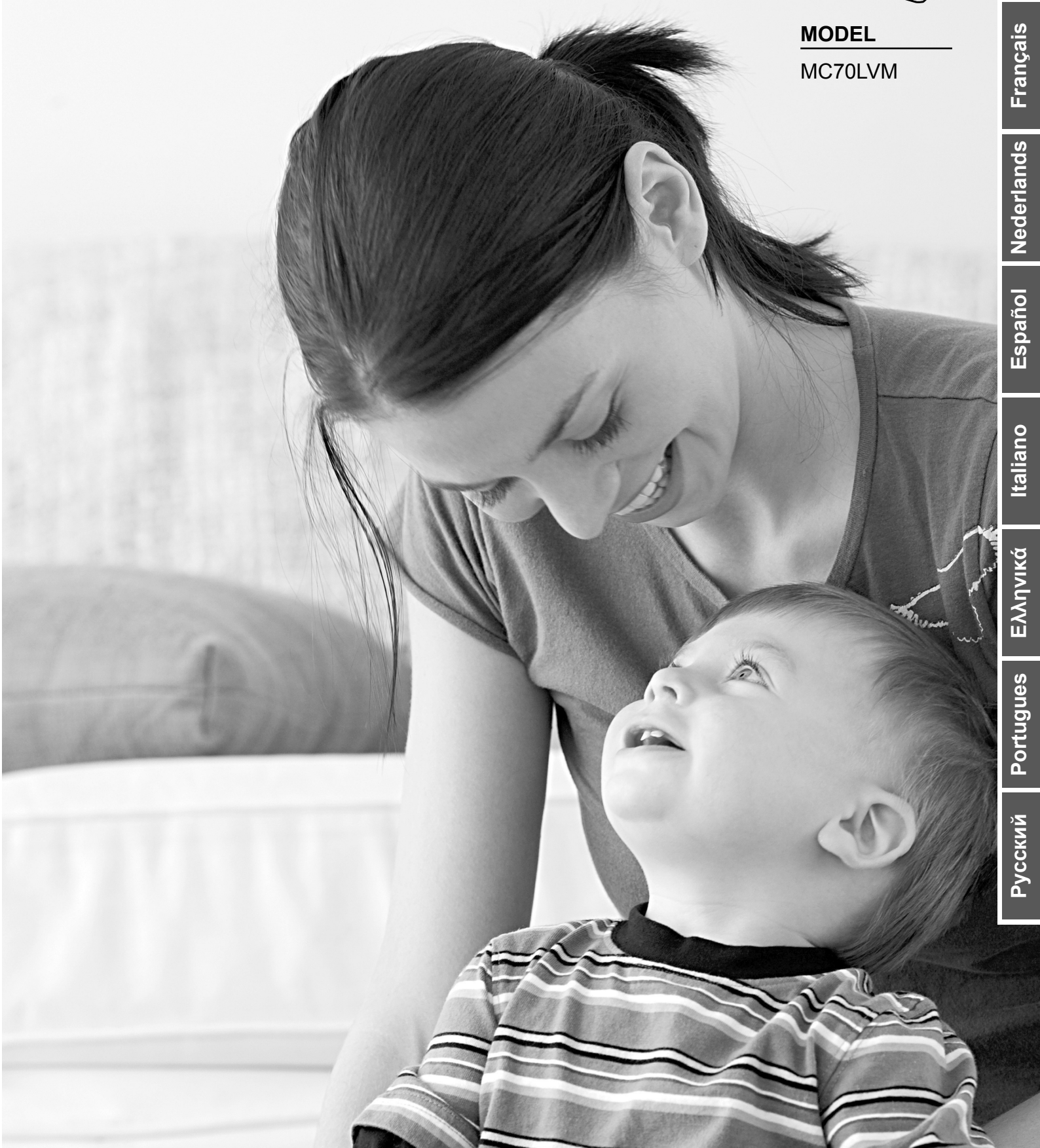

English

Deutsch

Français

Nederlands

Español

Italiano

Ελληνικά

Portugues

Русский

# Features

## About air purifying

**The powerful suction of a high airflow rate captures dust, pollen, etc.**

- The purifying capacity improves as the airflow rate increases.

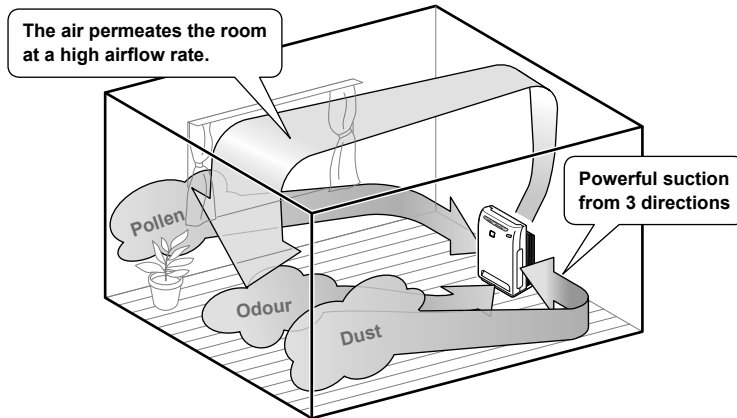

### Effective against pollen

With the high airflow rate, even pollen that readily settles because of its large particle size is quickly caught.

## Deodorising and decomposing odour in the air

**The streamer discharge decomposes absorbed odour.**

- The decomposition cycle that maintains deodorising capability.

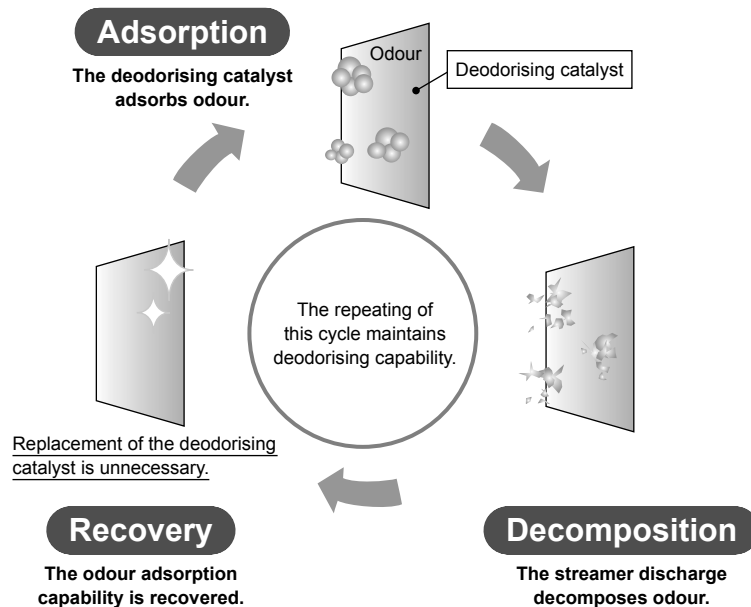

## What is the “Streamer” function?

This function uses a “streamer discharge”, a type of plasma discharge, to generate high-speed electrons with strong oxidation power inside the air purifier, reducing or removing odour swiftly. (The high-speed electrons are generated and absorbed within the unit to ensure your safety.)

The hissing sound of the streamer discharge may be heard during operation. It does not indicate any operational issue. In addition, the sound may become lower or the sound quality may change according to the operating environment. These cases are also not operational issues. You may smell an odour as a particle of ozone is generated. The amount is negligible, and does not harm your health.

# CONTENTS

## Read before Operation

<b>Features .....</b>	<b>1</b>
<b>Safety Precautions .....</b>	<b>3</b>
<b>Name and Operation of Each Part .....</b>	<b>6</b>
<b>Preparation before Operation .....</b>	<b>9</b>

## Operation

<b>How to Operate .....</b>	<b>13</b>
<b>Start / Stop, Airflow Rate, Turbo, Anti-Pollen, Sleep Mode, OFF TIMER, Display Lamp</b>	

## Care and Cleaning



<b>Quick Reference Table of Maintenance .....</b>	<b>15</b>
<b>Removing and Attaching Each Part .....</b>	<b>17</b>
<b>Cleaning of UNIT1 and UNIT2 .....</b>	<b>19</b>
<b>Replacement of the Pleated Filter .....</b>	<b>21</b>

## Troubleshooting

<b>Sensitivity Setting of the Air Quality Sensor (dust sensor) .....</b>	<b>22</b>
<b>Frequently Asked Questions .....</b>	<b>23</b>
<b>“If these lamps light or blink”</b>	
<b>Troubleshooting .....</b>	<b>24</b>

# Safety Precautions

- Before use, read these Safety Precautions to ensure proper handling of equipment.
- The precautions used in this manual are classified into the following two types. Both contain important safety information, therefore observe them at all times.

 <b>WARNING</b>	Improper handling may lead to serious injury or even death.	 <b>CAUTION</b>	Improper handling may lead to injury or property damage. In some situations, the consequences may be grave.
---	---	---	--

- The icons used in this manual mean the following.

	Never do.		Be sure to follow the instructions.		Disconnect the power plug.		Keep away from flames.
	Do not disassemble.		Do not handle with wet hands.		Do not wet.		

- After reading this manual, keep it in a handy place for future reference by users.

## WARNING

### Power supply cord and plug



- **Use only a 220-240V power supply.**  
Other power supplies may lead to fire or electric shock.
- **Do not damage, remodel, bend unreasonably, pull, twist or use the power supply cord bundled up.**  
**Also, do not place heavy objects on or pinch the power supply cord.**  
Damage to the power supply cord may lead to fire or electric shock.
- **Do not use the unit when the power supply cord or the power plug is damaged or plugged loosely into an electrical socket.**  
A damaged or loose cord or plug may lead to fire because of a short circuit or electric shock.
- **Do not use the unit beyond the rating of the electrical socket or branching device.**  
Exceeding the rating of multiple socket outlets may lead to fire because of overheating.
- **Do not connect or disconnect the power plug to turn the unit ON / OFF.**  
Abusive handling may lead to electric shock or fire because of overheating.

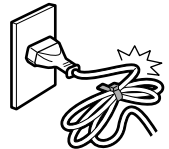

- **Insert the power plug into the electrical socket all the way to the base.**  
Incomplete connections may lead to electric shock or fire because of overheating.
- **Periodically clean the dust and other matter from the power plug with a dry cloth.**  
Insulation failure caused by humidity or other factors may lead to fire.
- **Stop operation and disconnect the power plug if you detect anything strange such as burning odours.**  
Continued use of the unit without resolving abnormalities such as burning odours may lead to electric shock or fire because of overheating.  
Consult your dealer.
- **If the power supply cord is damaged, it must be replaced by the manufacturer, dealer or qualified persons in order to avoid a hazard.**  
A damaged cord may lead to electric shock or fire because of overheating.
- **To reduce the risk of electric shock, this equipment has a polarized plug (one blade is wider than the other). This plug will fit in a polarized outlet only one way. If the plug does not fit fully in the outlet, reverse the plug. If it still does not fit, contact qualified personnel to install the proper outlet. Do not alter the plug in any way.**



- **Before cleaning or relocating the unit, stop operation and disconnect the power plug from the electrical socket.**  
Handling the unit while it is plugged in may lead to electric shock or damage.

### Main unit

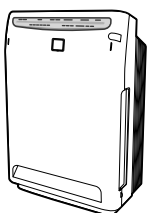

- **Do not use the unit anywhere there is airborne oil such as machine oil.**  
Airborne oil may lead to cracking, electric shock or ignition.
- **Do not use the unit anywhere there are abundant oil vapours such as in kitchens, combustible or corrosive gases, or metallic dust.**  
These kinds of environments may lead to fire or damage.
- **Keep fingers and objects out of the air inlets, air outlet and other openings.**  
Improper handling may lead to electric shock, injury or damage.
- **Do not wet the air outlet or unit frame.**  
Contact with water may lead to fire or electric shock.

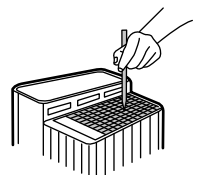

## WARNING

### Main unit

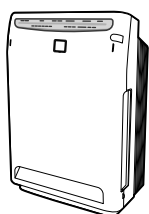

- **Do not use combustible substances, i.e., hair spray, insecticides, etc., near the unit.**

Do not wipe the unit with benzene or thinner.  
These substances may lead to cracking, electric shock or ignition.

- **Use a neutral detergent to clean the unit.**

Use of chlorine or acidic detergents to clean the unit may generate harmful gas and harm health.

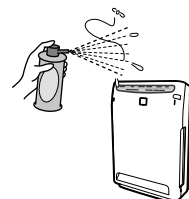

- **These servicing instructions are for use by qualified personnel only.**

To reduce the risk of electric shock, do not perform any servicing other than that contained in the operating instructions unless you are a professional and qualified to do so.



- **Keep cigarettes, incense and other naked flames away from the unit.**

Naked flames may lead to fire.



- **Do not disassemble, remodel or service the unit by yourself.**

Improper handling may lead to fire, electric shock or injury.  
Consult your dealer.



- **Do not operate the unit with wet hands.**

Contact with water may lead to electric shock.



- **Do not use the unit anywhere which is very humid such as bathrooms or which experiences sudden temperature changes such as cold storage boxes.**

Improper environments may lead to electric shock or damage.

## CAUTION

### Power supply cord and plug



- **Hold the power plug – not the power supply cord – and pull to disconnect the unit.**

Pulling on the power supply cord may lead to fire or electric shock because of short circuits.

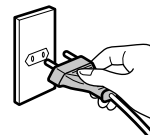

- **Before long periods of disuse, disconnect the power plug from the electrical socket.**

Degraded insulation may lead to electric shock, current leaks or fire.

### Main unit

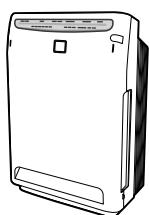

- **Do not use the unit anywhere it is exposed to direct sunlight, rain or wind.**

Overheating or contact with water may lead to fire or electric shock.

- **Do not use the unit anywhere which is hot such as near heaters.**

High temperature may discolour or deform the unit.

- **Do not block the air inlets or air outlet with laundry, cloth, curtains, etc.**

Adhered lint may obstruct the air passage, possibly leading to overheating and fire.

- **Do not use the unit on an uneven floor.**

If the unit topples over, water may spill from it, possibly wetting furniture or leading to fire or electric shock.

If the unit topples over, put it upright immediately.

- **Do not use the unit anywhere chemicals are handled.**

Volatile chemicals or solvents (found in hospitals, factories, test labs, beauty salons, photo developing labs, etc.) may degrade mechanical parts, possibly causing water leaks which may wet furniture, etc.

- **Do not use powders such as cosmetics near the unit.**

Contact with powders may lead to electric shock or damage.

- **Do not use the unit in cramped spaces such as closets.**

Poor ventilation may lead to overheating and fire.

# Safety Precautions

## CAUTION

### Main unit

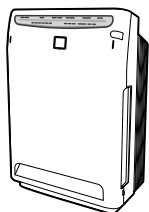

- **Do not expose plants or animals to direct air currents from the unit.**  
Overexposure to air currents may have adverse effects.
- **Keep fish tanks, vases and other water containers away from the unit.**  
Water infiltration into the unit may lead to electric shock, fire or damage.
- **Do not climb, sit or lean on the unit.**  
Falling or toppling over may lead to injury.
- **Do not remove the filter with the unit lying on its side.**  
Handling of this sort facilitates dust infiltration, possibly leading to fire or electric shock.
- **Do not use the unit close to lighting equipment (within 1m).**  
The response of the main unit to the signal from the remote controller may be weakened and the colour of the unit may change.

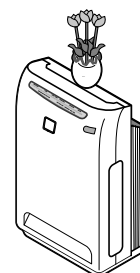

- **Regularly ventilate the room when using the unit in conjunction with combustion appliances.**  
Inadequate ventilation may lead to carbon monoxide poisoning.  
This product does not remove carbon monoxide.
- **This product is not intended to be used by persons with reduced physical, sensory or mental capabilities, or with a lack of operation knowledge, unless they are given supervision or instruction concerning appliance use by the person responsible for their safety. Keep the appliance out of children's reach to ensure that they do not play with it.**
- **Unplug the unit during cleaning.**  
Handling the unit while it is plugged in may lead to electric shock or damage.
- **This equipment should be inspected frequently and collected dirt removed from it regularly to prevent excessive accumulation which may result in flashover or a risk of fire.**

### Other



- **If you use the unit where pets are kept, be careful that pets do not urinate on the unit or bite the power supply cord.**  
This may lead to electric shock or fire. In the event of abuse by pets, stop operation, disconnect the power plug and consult your dealer.
- **Do not use combustion appliances where they are directly exposed to air currents from the air outlet.**  
Incomplete combustion by the combustion appliance may lead to carbon monoxide poisoning, etc.
- **As using indoor fumigating insecticides, stop operation to prevent chemicals from being sucked into the unit.**  
Because chemicals accumulate inside the unit, some persons may, depending on their physical condition, be hypersensitive and have their health jeopardized as a result.



## Precautions during use

- **Keep TVs, radios, stereos, radio clocks and antenna wires at least 2m away from the unit.**  
The effects of the power circuit inside the unit and cable may cause a distorted TV picture or noise.  
(However, audio interference may occur even beyond 2m depending on the strength of the electric waves. Reception is particularly hindered when using indoor antennas, therefore distance antennas far enough away to prevent noise from being picked up.)
- **Do not use the unit in the place of kitchen fans or stove hoods.**  
This kind of use may shorten the service life of the prefilter and the pleated filter, possibly leading to damage.
- **Do not use the unit to preserve artwork, academic materials, etc., or for commercial or other special applications.**  
This kind of use may place the quality of preserved objects.
- **Correctly attach parts after cleaning the unit.**  
Using the unit with parts such as filters removed may lead to damage.

### Streamer discharge and electric dust collection

- Odour may escape from the air outlet due to the slight amount of ozone generated, but the amount is negligible and human health is not affected.

This product does not remove the harmful substances (carbon monoxide, etc.) in cigarette smoke.

# Name and Operation of Each Part

## Front

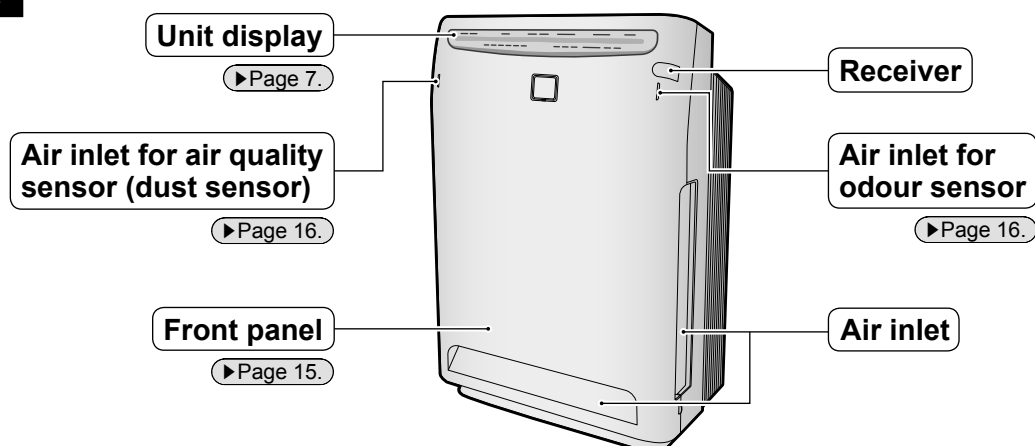

## Rear

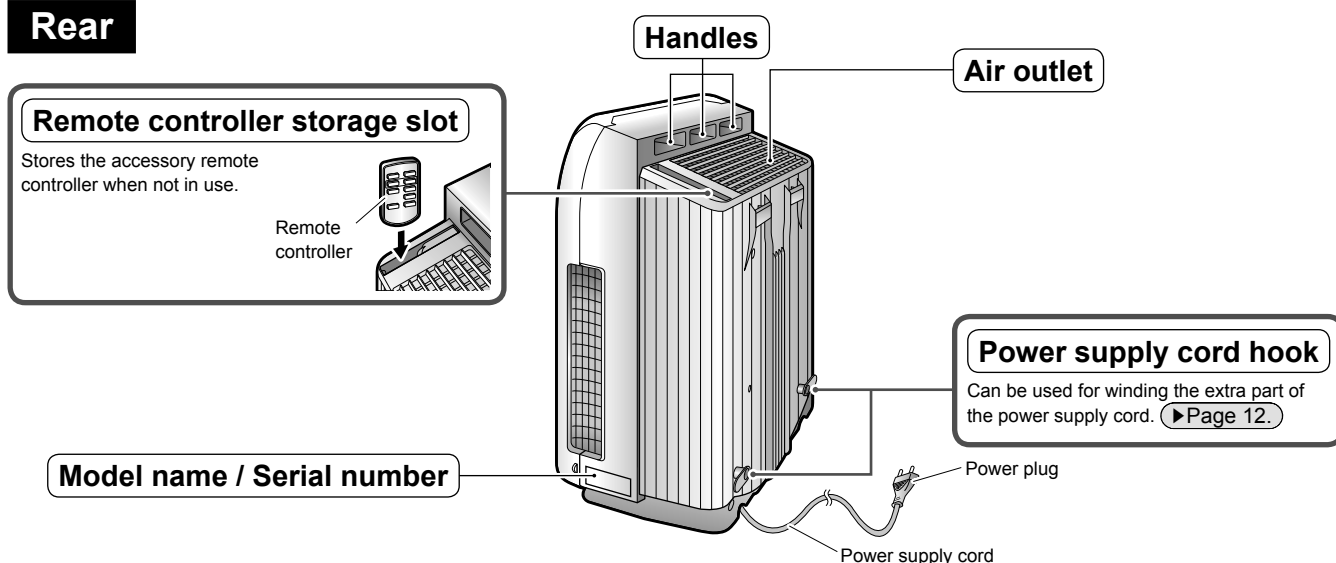

## Inside of the unit

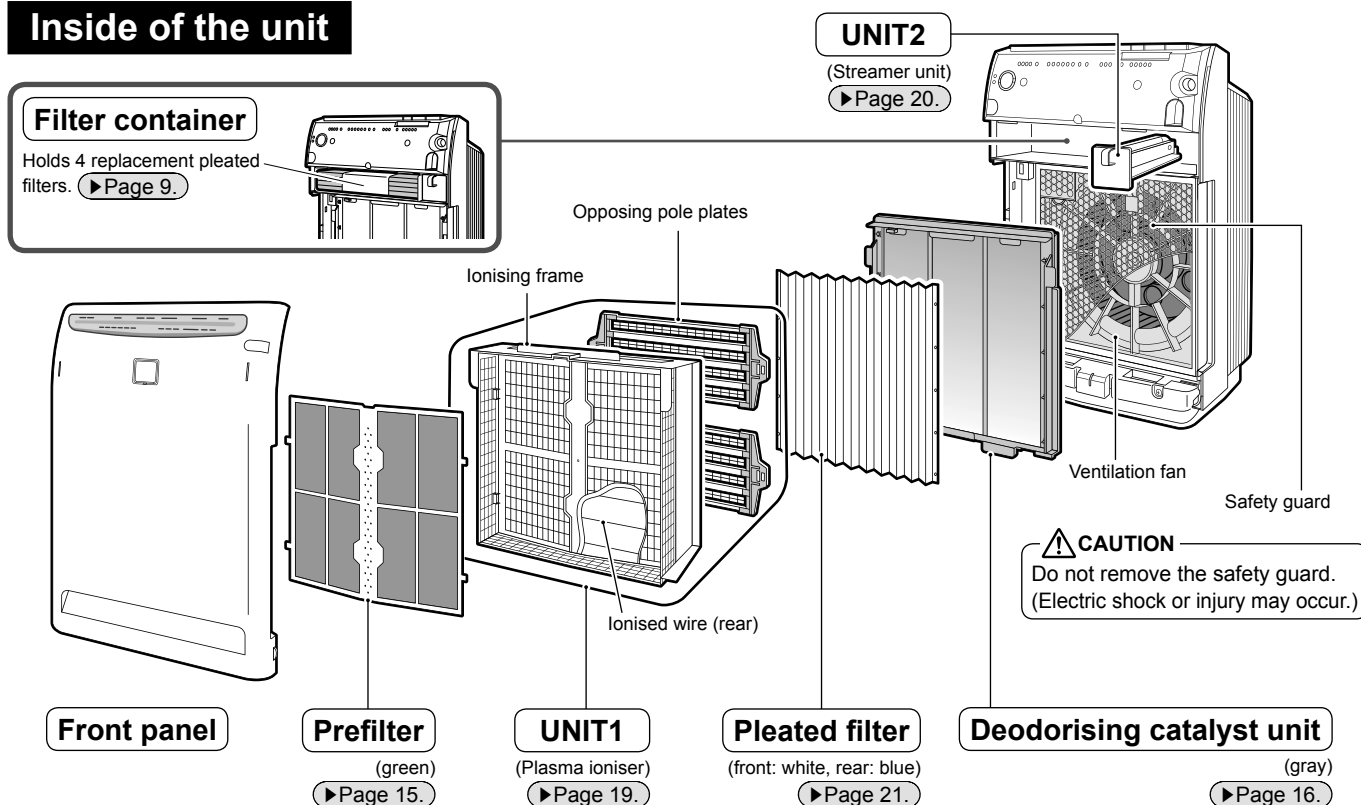

# Name and Operation of Each Part

Remote controller

▶Page 13, 14.

Child proof lock button

It prevents small children from mishandling the unit.

ON / OFF button

Fan setting button

Auto fan button

Turbo button

OFF TIMER button

Anti-pollen button

Sleep mode button

Brightness adjustment button

The brightness of the unit display lamp can be adjusted.

Unit display

Child proof lock lamp (orange)

Auto fan lamp (yellow)

Airflow rate lamp (green)

An airflow rate lamp indicates the airflow rate during “ (Auto fan)” and “airflow manual” operation.

Air quality sensor lamp (dust sensor)

The three-colour indicators (green, yellow, red) indicate how unclean the air is.

• When the air is clean, the green lamp lights up.

■ In the following case, only the green lamp lights up for the initial 7 seconds regardless of the uncleanness level.

1) Operation directly after attaching the front panel and UNIT1

2) Operation directly after reconnecting the power plug

■ When the sensitivity of the air quality sensor is poor, change the setting.

▶Page 22.

■ The sensitivity of the air quality sensor may fall depending on the installation site or the size of particles.

If this bothers you, change the installation site of the unit ▶Page 11. or adjust the sensitivity of the air quality sensor. ▶Page 22.

Dust

Low

High

Lights up

Green

Yellow

Green

Red

Yellow

Green

Detectable	Cigarette smoke, pollen, ticks, house dust, animal hair, diesel soot
Sometimes detectable	Steam, oil vapours

7



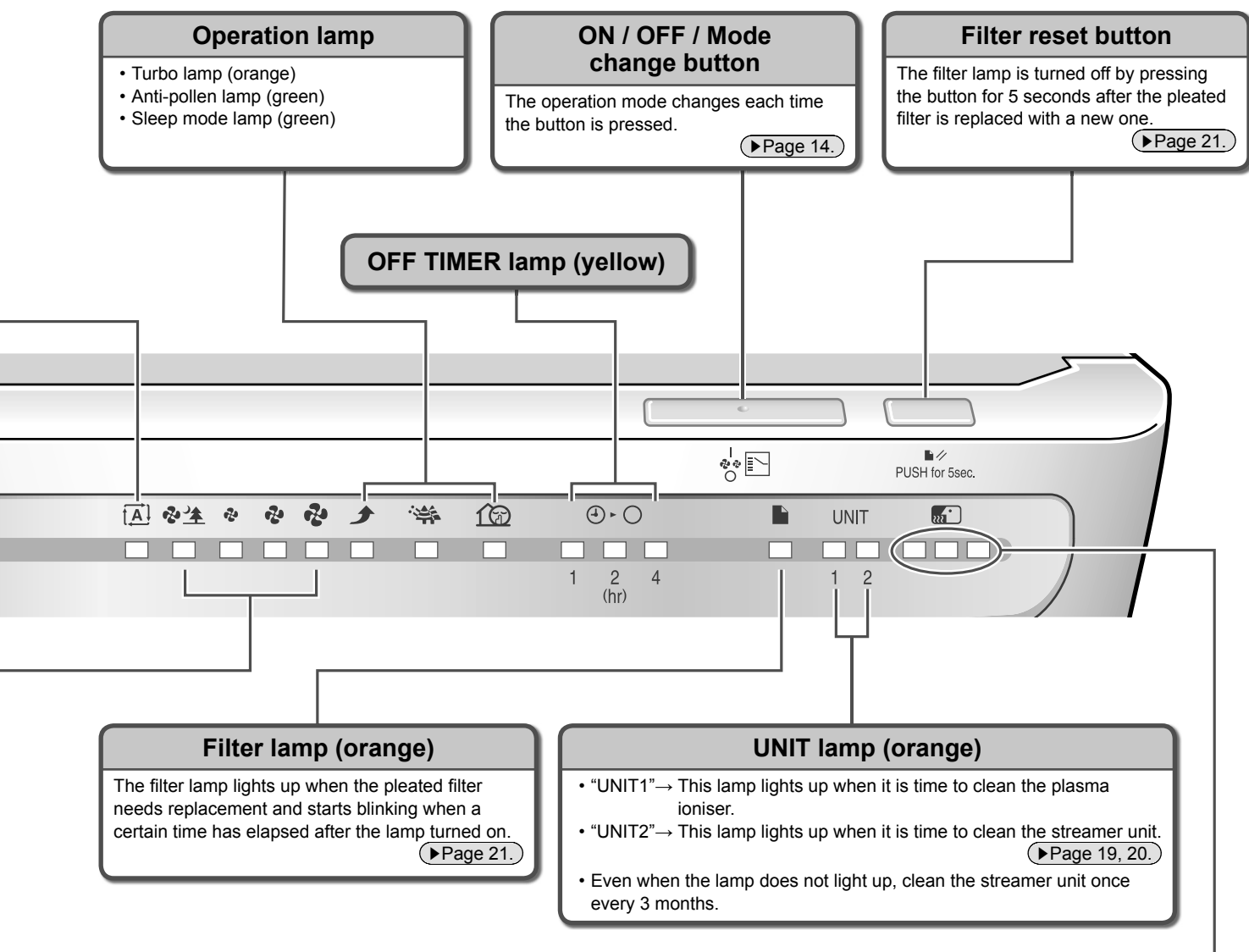

### Odour sensor lamp

**The three-colour indicators (green, yellow, red) indicate the odour level.**

- When the air is clean, the green lamp lights up.

■ **In the following case, only the green lamp lights up for the initial 1 minute. The initial level of odour is recorded as the standard level.**

- 1) Operation directly after attaching the front panel and UNIT1
- 2) Operation directly after reconnecting the power plug

- If the odour level remains constant without intensifying or weakening, the odour sensor may not detect even strong odours.
- The odour sensor may not detect certain types of odours such as pet odours other than ammonia, garlic, etc.
- Even if only the green lamp lights up, you may notice some smell because the sensitivity is different among individuals. If bothered by odours, set airflow manual operation and run the unit at a higher airflow rate.

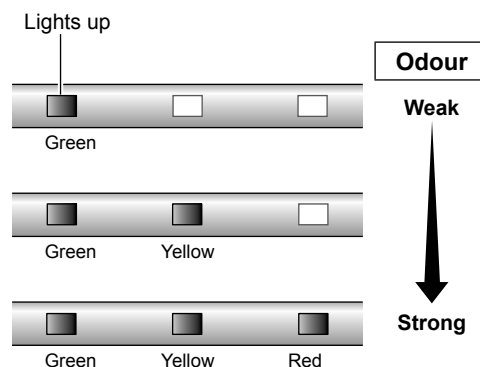

Detectable	Cigarette odours, cooking odours, pet and toilet odours, raw waste odours, mildew odours, sprays, alcohol
Sometimes detectable	Sudden changes in temperature and humidity, odourless gases such as carbon monoxide, steam, oil vapours, gas from combustion appliances

# Preparation before Operation

## ■ Accessories check

Confirm all the accessories are included.

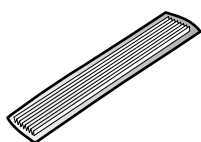
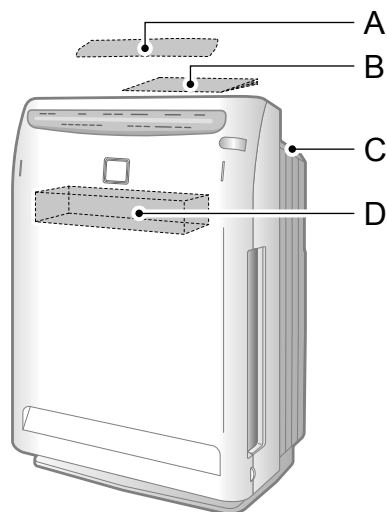

A: Pleated filter...1 sheet  
< For initial installation >  
Inside cushion

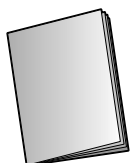

B: Operation manual...1 book  
(This booklet)  
Inside package



C: Remote controller...1 unit  
In remote controller  
storage slot

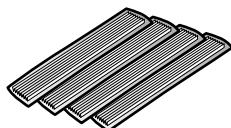

D: Pleated filters...4 sheets  
< Replacement filters >  
In filter container

## ■ How to attach the pleated filter

Make sure to attach the pleated filter before starting operation.

### 1 Remove the front panel.

- Push the 2 clips (right and left), and pull the front panel upward and remove it.

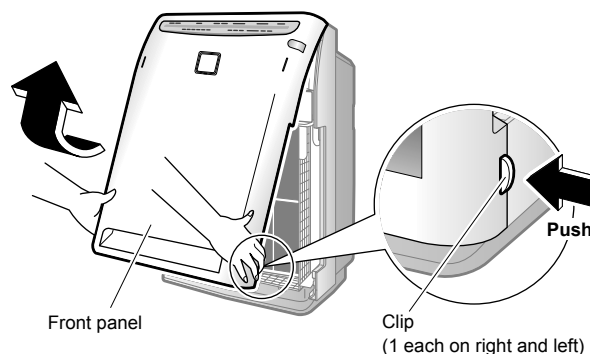

### 2 Remove UNIT1.

- Holding UNIT1 by the handles, pull UNIT1 upward and remove it.

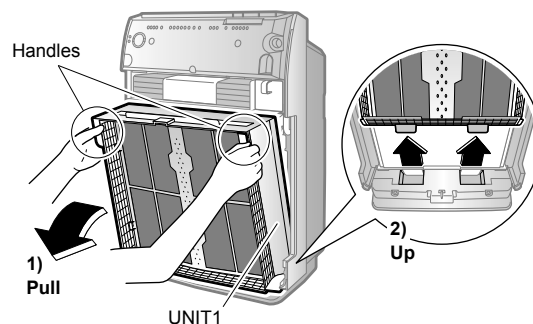

### 3 Remove the deodorising catalyst unit.

- Holding the deodorising catalyst unit by the handles, pull the deodorising catalyst unit upward and remove it.

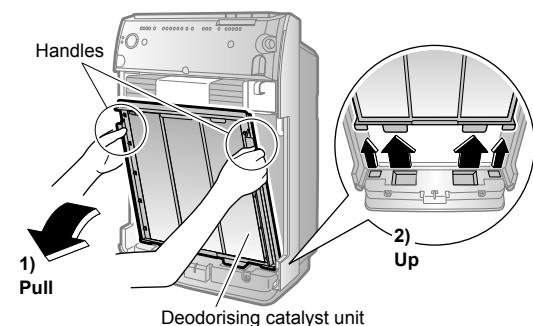

## 4 Attach the pleated filter.

Make sure to set the prefilter (green) and the pleated filter (front: white, rear: blue) in place. If you operate the unit without them, the unit may be damaged.

- 1) Fit the holes (5 each on the right and left) of the pleated filter to the fixing lugs (5 each on the right and left) of the deodorising catalyst unit.

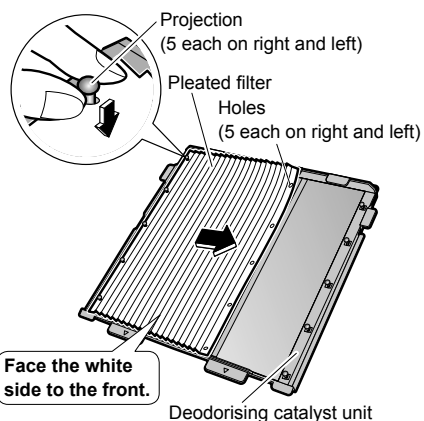

- 2) Insert the pleated filter underneath the tabs (4 locations) at the top and bottom of the deodorising catalyst unit.

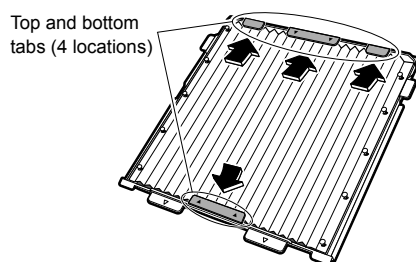

- Unit performance drops if the pleated filter is attached backward.

## 5 Attach the deodorising catalyst unit.

- Holding the deodorising catalyst unit by the handles, fit the projections into the grooves (4 locations) at the bottom of the main unit and press the deodorising catalyst unit into the main unit.

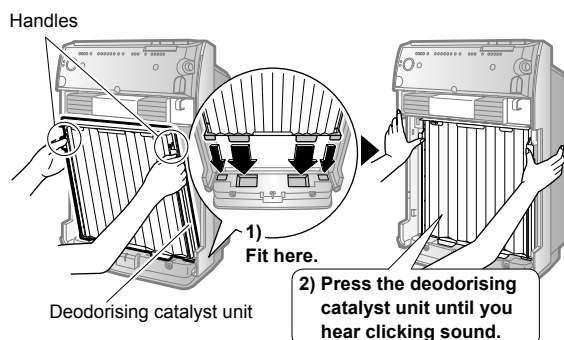

## 6 Attach UNIT1.

- Holding UNIT1 by the handles, fit the projections into the grooves (2 locations) at the bottom of the main unit, and press UNIT1 into the main unit.

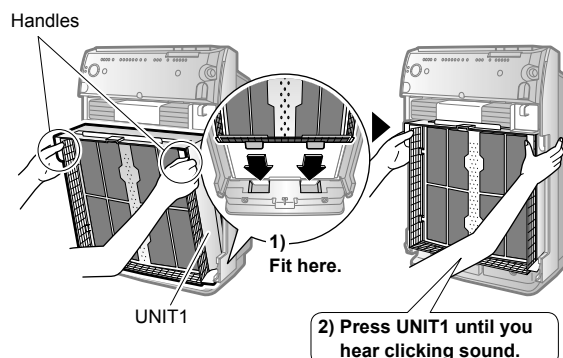

## 7 Attach the front panel.

- Fasten the top hooks (2 locations) of the front panel to the top grooves (2 locations) of the main unit and then close the front panel.

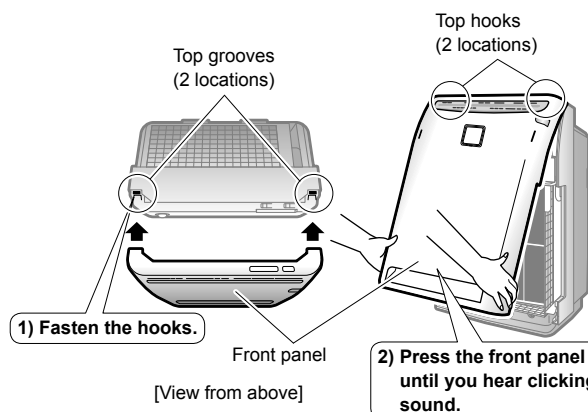

If the front panel is improperly set, the safety switch may be activated. Operation may not start. ▶Page 16.

# Preparation before Operation

## ■ Installation of the unit

Installed on a table or the floor

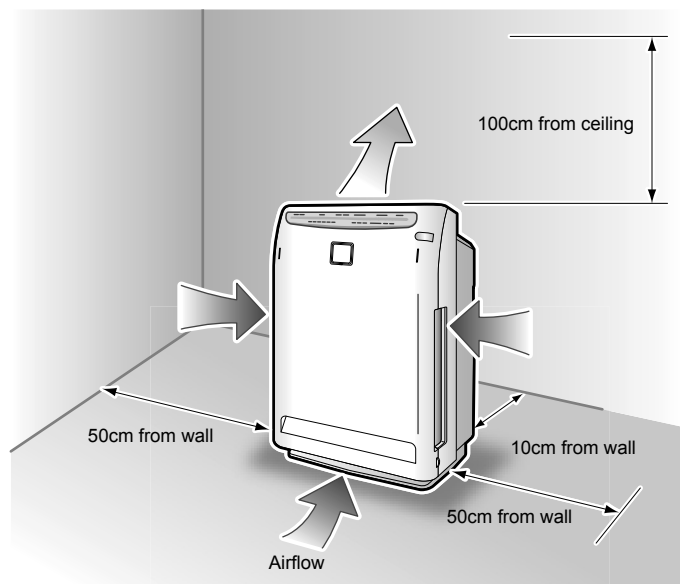

### ⚠ CAUTION

- The wall where the air purifier is set may get dirty depending on the type of wall and environment, even if you follow the specified dimensions of left. In such cases, move the unit a safe distance away from the wall.
- If the air purifier is used for a long time at the same location, the bottom of the unit and floor may become dirty due to the suction air flow from the bottom of the unit. Periodic cleaning is recommended.

### ATTENTION

- The air is blown slightly to the right, but nothing is wrong with the unit.
- Select a location which allows the air to reach the entire room.
- Place the air purifier on a flat area where it is stable. If the floor is uneven, the unit may vibrate excessively.

### Hints for smart installation

- To remove house dust, it is effective to install the unit at a lower position in the room. To remove cigarette smoke, it is effective to install the unit in a higher part of the room.
- If you install the air purifier opposite the air conditioner, the circulation effect is enhanced. The unit controls unevenness in the room temperature while cleaning the air during heating or cooling operation.
- Keep TVs, radios and stereos 2m or more away from the unit.  
(The effects of the power circuit inside the unit and cable may cause a distorted TV picture or noise.)  
Keep cordless phones or atomic radio clocks away from this unit also.

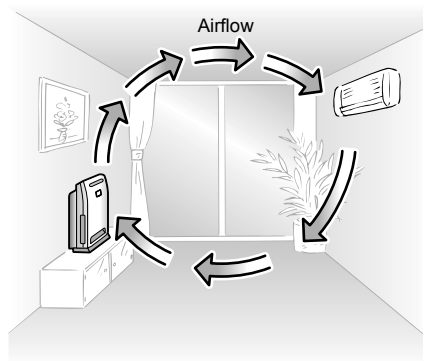

### Do not use the unit in the following places.

- Do not use the unit in a location exposed to direct sunlight.  
(The response of the main unit to the signal from the remote controller may be weakened and the colour may change.)
- Do not use the unit in locations of high temperature.  
(Heat may discolour and deform the unit.)

## ■ Preparation of remote controller

A battery is already set in the remote controller.

- The remote controller can be used only after pulling out the clear sheet.

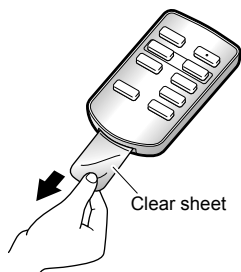

### Battery replacement

- 1 Move the tab of the cover on the rear of the remote controller in the direction of the arrow.
- 2 Pull out the cover.
- 3 Replace the battery.
- 4 Close the cover to its original position.

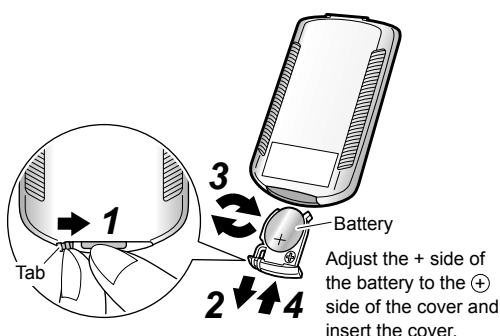

## ■ Insert the power plug into an electrical socket.

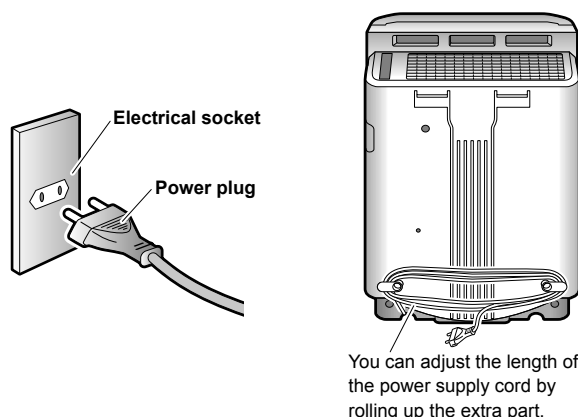

### How to use

- Point the transmitter of the remote controller toward the receiver of the unit.  
If there is an obstruction to the signal, such as a curtain, the unit may not receive the signal.
- The distance from which the remote controller can transmit is about 6m.

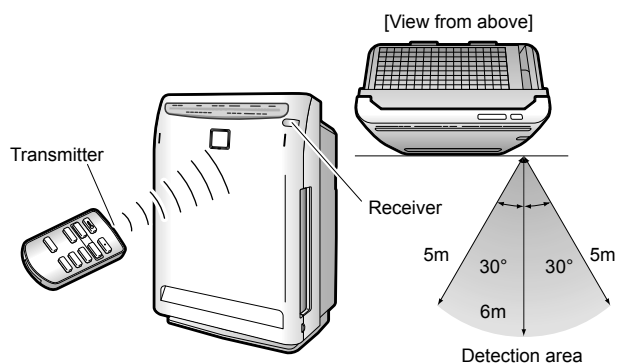

### NOTE

#### Battery



- Store the batteries where babies and children can not reach them.  
If, by chance, a battery is swallowed, make sure to contact a doctor immediately.
- When discarding batteries, cover the terminals of the batteries with tape.  
If mixed with other metal or batteries, heat, explosion or combustion may occur.
- The replacement target is about 1 year but if reception becomes difficult, replace the battery with a new coin type CR2025 (lithium) battery.
- It may be necessary to replace a coin type battery which is approaching its expiration date before the recommended date.
- In order to prevent malfunctions or injuries due to leaking or explosions, make sure to remove the coin type battery when the unit will not be used for a long period of time.
- The coin type battery which comes with the remote controller is for the initial operation. The coin type battery may run down in less than 1 year.

#### Remote controller



- Be careful not to drop or get the remote controller wet. (It causes malfunction.)
- The signals may not be received very well because of electronic lighting style fluorescent lamps (such as inverter fluorescent lamps) in the same room.
- Do not use the remote controller close to the lighting equipment (within 1m).  
(The sensitivity of the main unit to the signal from the remote controller may be weakened and the colour of the unit may change.)



# How to Operate



## To start the operation

Press  ON / OFF.



(Example of the initial display)

- Operation starts and the airflow rate lamp lights up.
- When you press  during operation, operation stops.
- When you press  next time, operation starts with the same settings as the previous operation.



### To prevent mishandling by small children

### Childproof lock



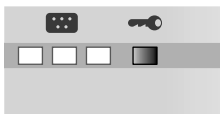

- Press  for about 2 seconds to engage the childproof lock.
  - You can release the childproof lock by pressing  again for about 2 seconds.
- You can also release the childproof lock when you disconnect the power plug once, and after 3 seconds or more, reconnect the power plug.



### To operate the unit according to the cleanness level of the air

### Auto fan operation

**Press**  **.**

- The auto fan lamp and one of the airflow rate lamps “ (Quiet)”, “ (Low)”, “ (Standard)”, or “ (High)” light up.



### To clean the air in the room quickly

## Turbo operation

**Press**  **.**



## To set the timer

## Timer operation

**Press**    .

- Each time the button is pressed, the OFF TIMER is set as follows.  
 └─ “1” (1 hour) → “2” (2 hour) → “4” (4 hour) → (Cancel) ─┘

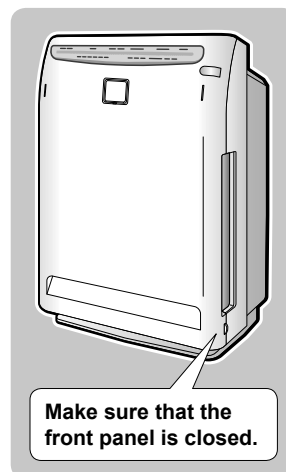
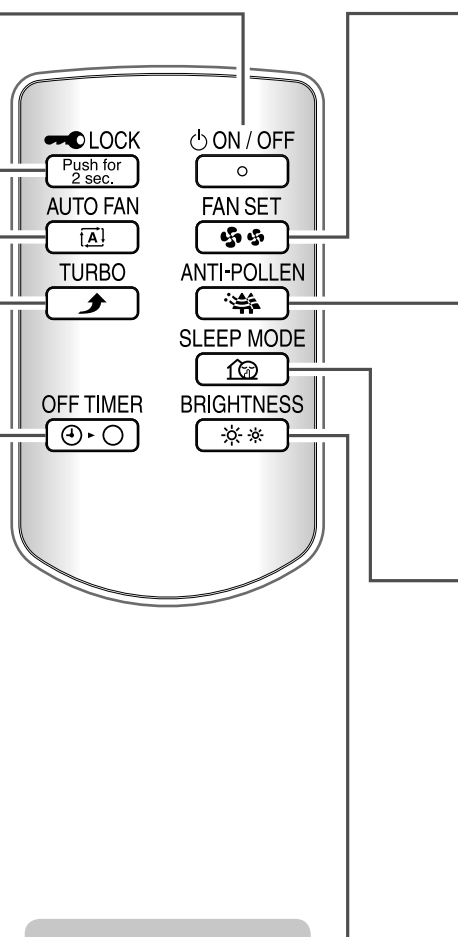

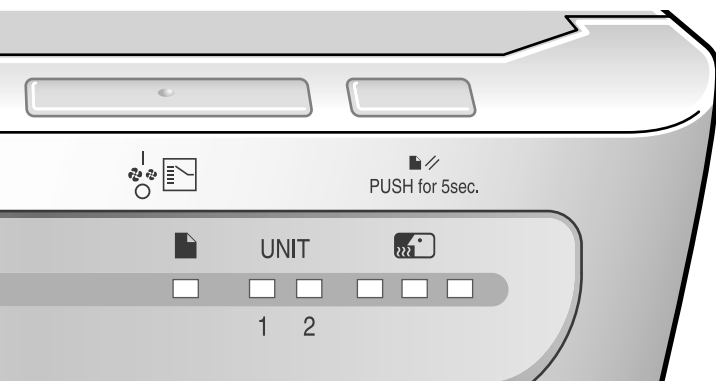

### Operation with the button on the unit

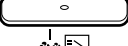
Press .

- The operation mode changes each time the button is pressed.

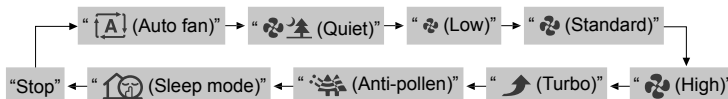

### ATTENTION

- Operation stops for safety when the front panel is opened during operation.

### ■When any malfunction occurs during operation

- If the unit display is abnormally lit or the signal from the remote controller can not be received during operation due to electric lighting or radio interference, disconnect the power plug once. After 3 seconds or more, reconnect the power plug and start operation.

### ■Start / Stop

- The default setting for the airflow rate is "A" (Auto fan). When you disconnect the power plug or remove the front panel, the setting for the airflow rate returns to "Auto fan".
- Before cleaning, make sure to stop operation and disconnect the power plug.

### ■Auto fan operation

- The airflow rate is automatically selected from "Quiet", "Low", "Standard", or "High" according to the uncleanness level of the air.
- The purifying capacity improves as the airflow rate increases.

### ■Turbo operation

- A high airflow rate quickly removes any contaminants in the air. This is convenient to use when cleaning the room.

### ■Quiet operation

- A gentle flow of air is discharged. Use this operation especially while sleeping. During the quiet operation, the deodorising performance decreases. If the room is not deodorised well, please use the "Standard" or stronger operation mode.

### ■Anti-pollen operation

- The airflow rate switches over between "Standard" and "Low" every 5 minutes and produces a moderate air stream to catch the pollen before it drops on the floor.

### ■Sleep mode operation

- The airflow rate is automatically selected from "Quiet" or "Low" according to the cleanliness level of the air.
- This is convenient to use when sleeping.

### ■Timer operation

- The remaining time is indicated by the OFF TIMER lamp.
- The set time can also be changed when the button is pressed while the timer is counting.

### ■Childproof lock

- While the lock is engaged, the operation of the unit and the remote controller are limited to prevent small children from mishandling them.

### To change the airflow manually

#### Airflow manual operation

Press .

- Each time the button is pressed, the airflow rate changes as follows.

→ "Quiet" → "Low" → "Standard" → "High"



### To clean pollen

#### Anti-pollen operation

Press .



### To operate quietly when you are sleeping

#### Sleep mode operation

Press .

- The sleep mode operation lamp and one of the airflow rate lamps "Quiet" or "Low" light up.

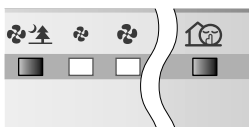

### To change the brightness of the unit display lamp

Press .

- The brightness of the unit display lamp changes each time the button is pressed.
- It is only the air quality sensor lamp and the odour sensor lamp which completely go off.

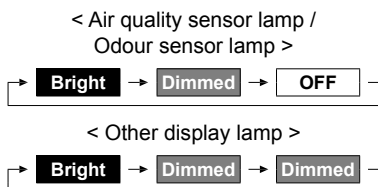

### NOTE

- Do not start or stop operation by disconnecting or reconnecting the power plug except in the case of malfunction.
- Do not move the unit during operation. It may cause operational issues or malfunction.

# Quick Reference Table of Maintenance

## WARNING

Before performing maintenance, stop the unit and disconnect the power plug. (It may cause electric shock or injury.)

**Remove the parts for maintenance in numerical order.**

For details on removing and attaching each part, see [▶Page 17.](#)

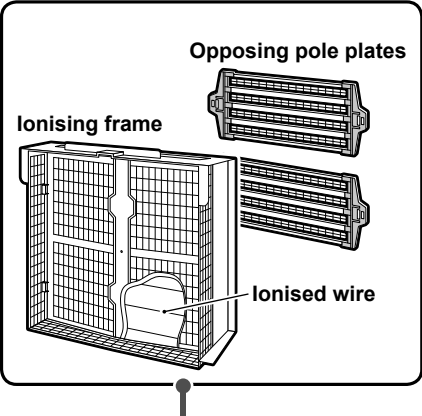
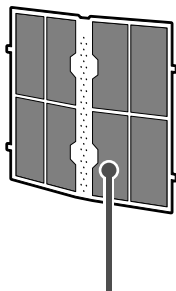
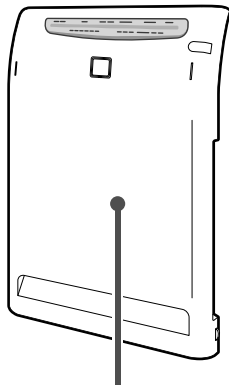

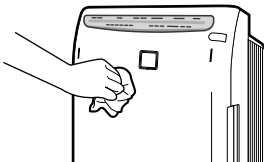
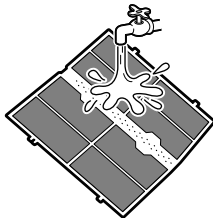
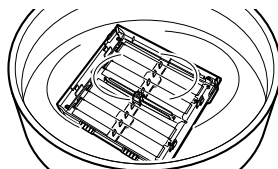
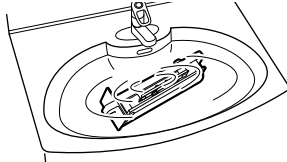
1	Front panel	2	Prefilter	3	UNIT1 (Plasma ioniser)	4	UNIT2 (Streamer unit)
				 ( The figure above shows UNIT1 after the opposing pole plates are removed. )			
<p>If it gets dirty</p> <p><b>Wipe</b></p>		<p>Once every 2 weeks</p> <p><b>Vacuum cleaner</b></p> <p><b>Rinse with water</b></p>		<p>If the “UNIT1” lamp lights</p> <p><b>Soak, drain and dry</b></p> <p><b>Wipe</b></p>		<p>Once every 3 months or if the “UNIT2” lamp lights</p> <p><b>Soak, drain and dry</b></p> <p><b>Wipe</b></p>	
<ul style="list-style-type: none"><li>• Wipe off the dirt with a cloth slightly moistened with water.</li><li>• In the case of heavy dirt, wipe it off with a cloth moistened with neutral detergent.</li><li>• Do not use hard brushes, etc.</li></ul>		<ul style="list-style-type: none"><li>• Use a vacuum cleaner to remove the dust from the prefilter, and wash it with water.</li><li>• In the case of heavy dirt, wash the prefilter with a soft brush or neutral detergent and dry it well in the shade.</li></ul> <div>Dry the prefilter completely before using it because the “UNIT1” lamp may light up if any water drops remain on the prefilter.</div>		<ul style="list-style-type: none"><li>• Use a vacuum cleaner to remove the dust.</li><li>• Soak in lukewarm water or water. (About 1 hour)</li><li>• Dry thoroughly after soaking.</li></ul> <div>Care and Cleaning ▶Page 19, 20.</div>			

## WARNING

- Do not use gasoline, benzene, thinner, scouring powder, kerosene, alcohol, etc.  
(Cracking, electric shock or fire may occur.)
- Do not wash the main unit with water.  
(Electric shock, fire or malfunction may occur.)

## NOTE

- When detergent is used, wipe the detergent off the surface to prevent any residue.
- Do not dry the prefilter in a place exposed to direct sunlight.
- Do not use hot water with a temperature of 50°C or higher for cleaning the parts.
- Do not dry the parts over a fire.  
It may cause discolouration or deformation of the parts and the parts may become unusable.



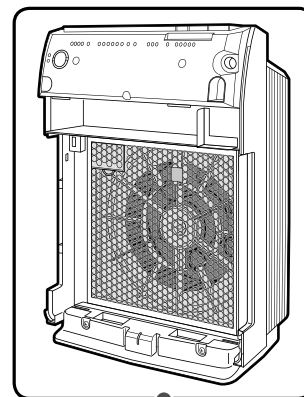
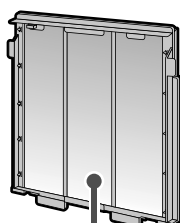
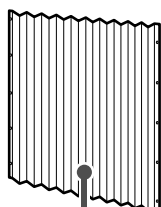

5 Pleated filter	6 Deodorising catalyst unit	7 Main unit or air inlet for sensor
<p>If the filter lamp lights up or blinks</p> <p><b>Replace</b></p>	<p>If it gets dirty</p> <p><b>Vacuum cleaner</b></p> <p>Can not be rinsed in water</p>	<p>If it is clogged</p> <p><b>Vacuum cleaner</b></p> <p><b>Wipe</b></p>
<p>Replacement ► Page 21.</p>	<ul style="list-style-type: none"> <li>• Use a vacuum cleaner to remove the dust.</li> <li>• If the deodorising catalyst unit frame becomes dirty, wipe off the dirt with a cloth slightly moistened with water. In the case of heavy dirt, wipe it off with a cloth moistened with neutral detergent.</li> <li>• Do not wash with water. (If the unit is washed with water, it will be deformed and become unusable.)</li> </ul>	<ul style="list-style-type: none"> <li>• If the main unit or the air inlet for the air quality / odour sensor is clogged with dust, use a vacuum cleaner to remove the dust.</li> <li>• For the main unit, wipe off the dirt with a cloth slightly moistened with water.</li> </ul>

## NOTE

- Be careful not to scratch the surface of the front panel or damage the projections on the rear of it after it is removed. The projections on the rear work as a safety switch that shuts power off when the front panel is opened. If they are damaged, operation can not start.

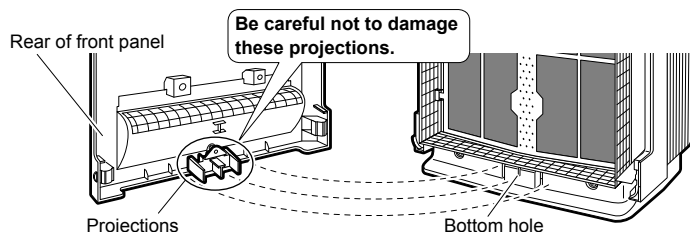

## WARNING

- Do not touch the inside of the hole at the bottom of the unit. (Electric shock may occur.)
- Consult your dealer if the unit is damaged and does not operate.

# Removing and Attaching Each Part

## Remove

### 1 Remove the front panel.

- Push the 2 clips (right and left), and pull the front panel upward and remove it.

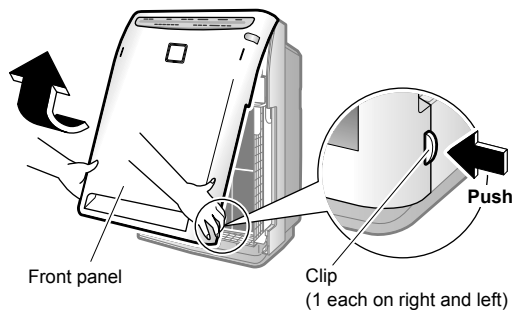

### 2 Remove the prefilter.

- Hold the indent and pull the prefilter. Then, unhook the tabs (4 locations) of the prefilter from the holes (2 each on the right and left) of UNIT1.

Pull the prefilter to remove it.

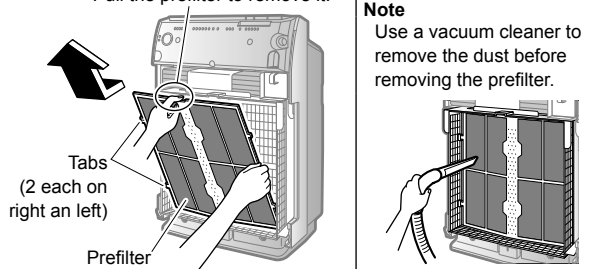

### 3 Remove UNIT1.

- Holding UNIT1 by the handles, pull UNIT1 upward and remove it.

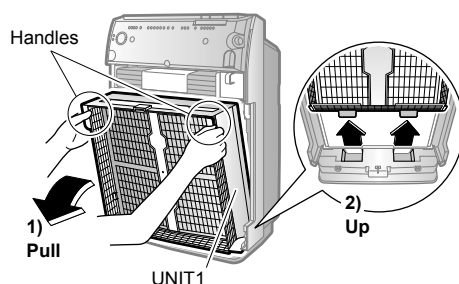

### 4 Remove the deodorising catalyst unit.

- Holding the deodorising catalyst unit by the handles, pull the deodorising catalyst unit upward and remove it.

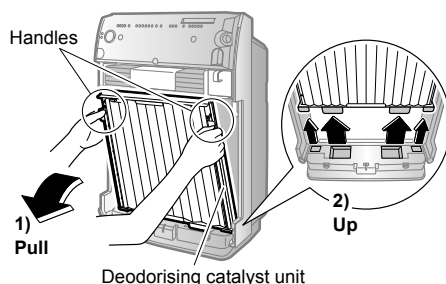

## Attach

### 1 Attach the deodorising catalyst unit.

- Holding the deodorising catalyst unit by the handles, fit the projections into the grooves (4 locations) at the bottom of the main unit and, press the deodorising catalyst unit into the main unit.

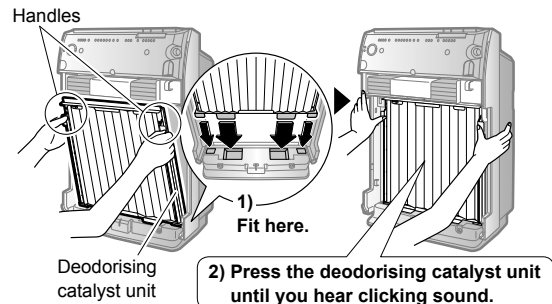

### 2 Attach UNIT1.

- Holding UNIT1 by the handles, fit the projections into the grooves (2 locations) at the bottom of the main unit, and press UNIT1 into the main unit.

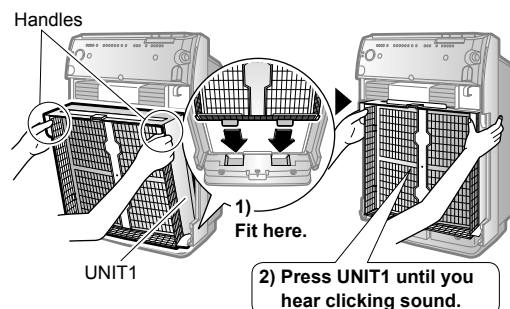

### 3 Attach the prefilter.

- Fit the tabs (4 locations) of the prefilter into the holes (2 each on the right and left) of UNIT1.

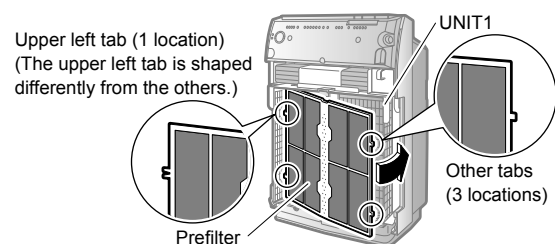

### 4 Attach the front panel.

- Fasten the top hooks (2 locations) of the front panel to the top grooves (2 locations) of the main unit and then close the front panel.

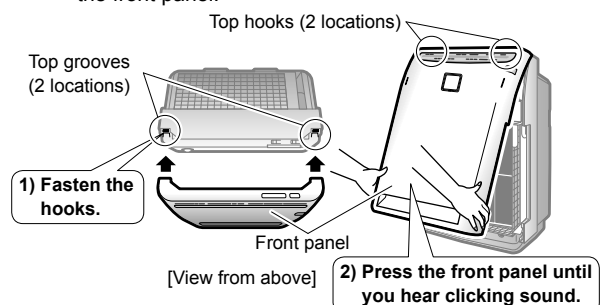

If the front panel is improperly set, the safety switch may be activated. Operation may not start. ▶Page 16.

## ■ Removing and attaching the opposing pole plates

### ⚠ CAUTION

Wear rubber gloves to remove and attach the opposing pole plates. Hands can be cut on the opposing pole plates and ionised wires.

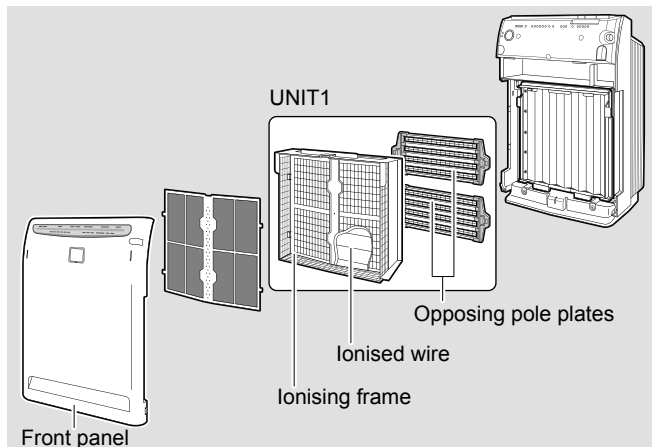

### Remove

#### 1 Remove the front panel and UNIT1.

►Page 17.

#### 2 Remove the opposing pole plates from the rear of UNIT1.

- Pinching together the white and green knobs (2 sets on the right and left), lift the opposing pole plate up and remove it.

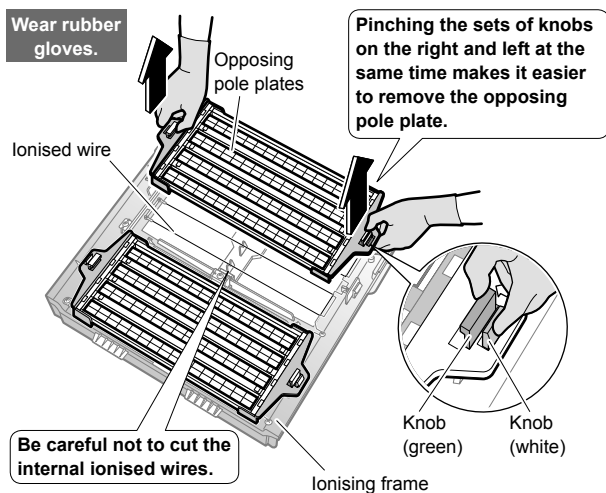

### Attach

#### 1 Attach the opposing pole plates.

- Fit the opposing pole plate over the knobs (2 sets on the right and left) on the ionising frame.

The opposing pole plates have no difference between the upper and the lower, or between the right and the left. Attach them so that the arrow is visible.

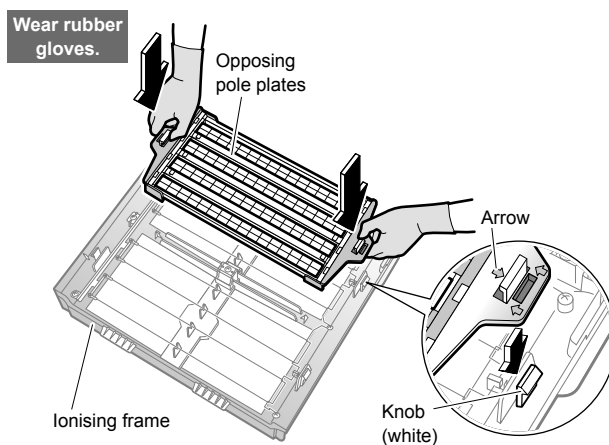

- Insert securely until it clicks.

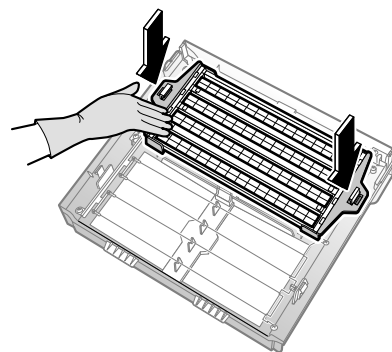

- Attach the other opposing pole plate.

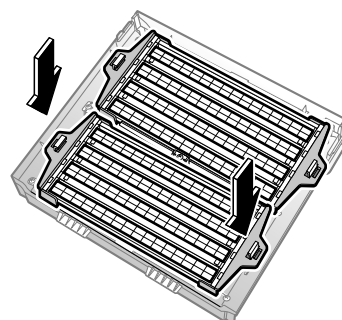

#### 2 Attach UNIT1 and the front panel.

►Page 17.

# Cleaning of UNIT1 and UNIT2

Time for cleaning	UNIT1: If the “UNIT1” lamp lights	
	UNIT2: Once every 3 months or if the “UNIT2” lamp lights	
Cleaning method	<div>Soak, drain and dry</div> <div>Wipe</div>	

If marking is a concern, clean the unit even if the “UNIT1” and “UNIT2” lamps do not light.

For details on removing and attaching each part, see ▶Page 17. .

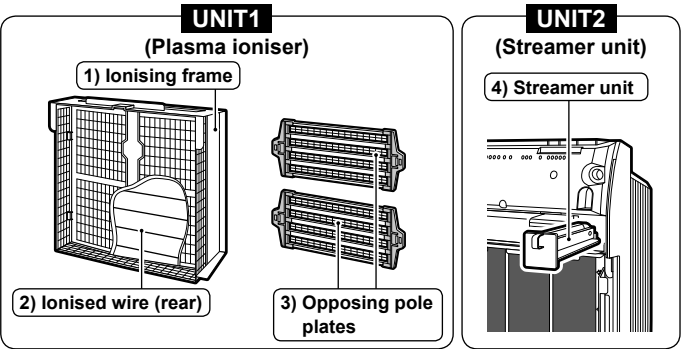

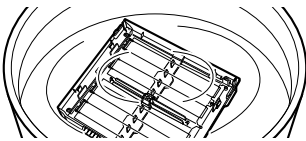
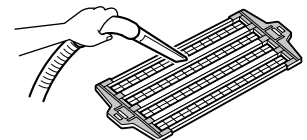
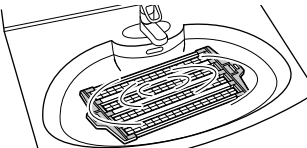
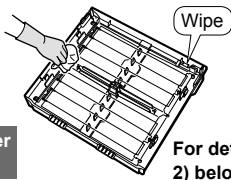
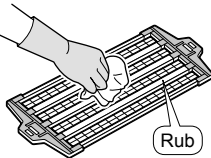
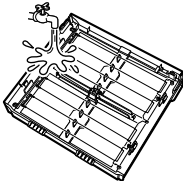
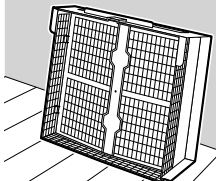
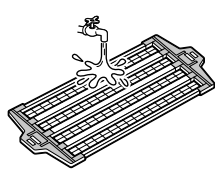
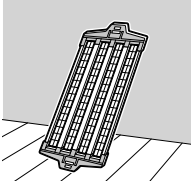
Procedure	UNIT1		
	1) Ionising frame	2) Ionised wire	3) Opposing pole plates
Remove the parts.	▶Page 17, 18.		▶Page 18.
Use a vacuum cleaner to remove the dust.			
Soak in lukewarm water or water. (About 1 hour)			
Remove dirt with a piece of cloth, soft brush, etc. <b>Wear rubber gloves.</b>	 <b>Wipe</b> <b>Wear rubber gloves.</b> For details, see 1) and 2) below.		 <b>Rub</b> <b>Wear rubber gloves.</b>
Rinse in running water and drain.	 		 
Dry in a well-ventilated, shaded place. (About 1 day)			
Attach the parts.	▶Page 17, 18.		▶Page 18.

## 1) Ionising frame (Remove dirt after soaking but before drying.)

- Remove dirt from plastic parts with a soft piece of cloth.
- Use a cotton swab, etc. to wipe away dirt in recesses and places where fingers do not fit.
- Do not leave any lint from cleaning cloths behind. Lint may lead to malfunctions.

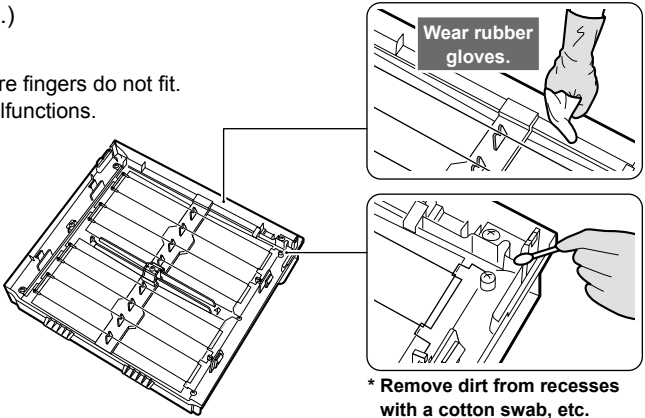

## CAUTION

### ■ Wear rubber gloves when wiping or rubbing the units.



- Hands can be cut on the opposing pole plates and ionised wires.

### ■ There are ionised wires on the rear of the opposing pole plates. Be careful not to snap these wires when removing and attaching the units.

- If the unit is operated with broken ionised wires, the "UNIT1" lamp lights. While the lamp is lit, dust collecting capacity is low.
- If any ionised wire is accidentally cut, it is necessary to replace the ionised wire with a new one. Consult your dealer.  
(Do not replace the ionised wire by yourself.)

## ATTENTION

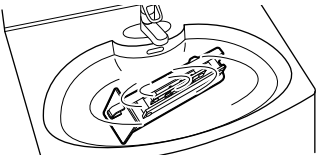
- Operation can be performed safely without the streamer unit installed on the main unit, but this degrades the deodorising performance. Use the main unit after the streamer unit is installed.

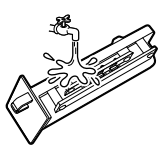
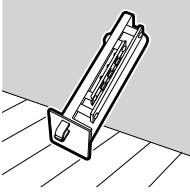
UNIT2	Notes
4) Streamer unit	
Open the front panel and pull out the streamer unit.	
	<ul style="list-style-type: none"> <li>• Do not remove the screws from the ionising frame or UNIT2. This may lead to damage.</li> </ul>
	<ul style="list-style-type: none"> <li>• Clean UNIT1 and UNIT2 somewhere which can be wet such as in a shower room or kitchen sink.</li> <li>• For stubborn dirt, soak UNIT1 and UNIT2 in lukewarm water or water in which neutral liquid detergent (i.e., kitchen cleaner, etc.) has been dissolved.</li> <li>• Use the amount of neutral liquid detergent indicated in the instructions for the detergent.</li> <li>• Do not use powdered, alkaline or acidic cleaner, and do not rub with hard brushes, etc. It may lead to deformation and damage.</li> <li>• If the needles inside UNIT2 are deformed, deodorising capacity diminishes.</li> </ul>
 <p><b>Wear rubber gloves.</b></p> <p>For details, see 4) below.</p>	
 	<ul style="list-style-type: none"> <li>• If detergent remains on UNIT1 or UNIT2, the "UNIT1" and "UNIT2" lamps do not go off after cleaning, therefore rinse off the detergent well.</li> <li>• Do not leave any lint from cleaning cloths behind. Lint may lead to malfunctions.</li> <li>• Plastic parts may deform or discolour if exposed to direct sunlight.</li> <li>• If water remains on UNIT1 or UNIT2, even in small quantities, the "UNIT1" and "UNIT2" lamps do not go off after cleaning, therefore dry them thoroughly in the shade.</li> </ul>
Reattach the streamer unit as before.	

## 2) Ionised wire (8 locations)

- Remove dirt from the ionised wires and surrounding plastic parts with a soft piece of cloth.

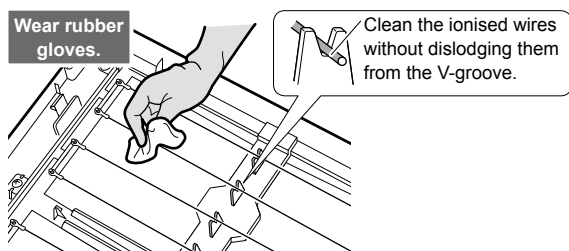

\* Wipe the ionised wires gently.  
Pulling on them forcefully may cause them to snap.

## 4) Streamer unit

- Wipe the needles with a cotton swab or a soft piece of cloth if they are dirty.
- Remove dirt from plastic parts (■) in internal areas with a cotton swab or a soft piece of cloth.
- Do not remove the screws.

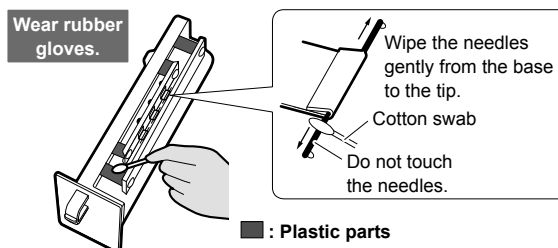

\* If the needles are deformed, deodorising capacity diminishes.

# Replacement of the Pleated Filter

Time for cleaning	<b>When the filter lamp in the display lights up or blinks</b>	
	It is not necessary to replace the pleated filter until the filter lamp lights up or blinks.	
Cleaning method	<b>Replace</b>	

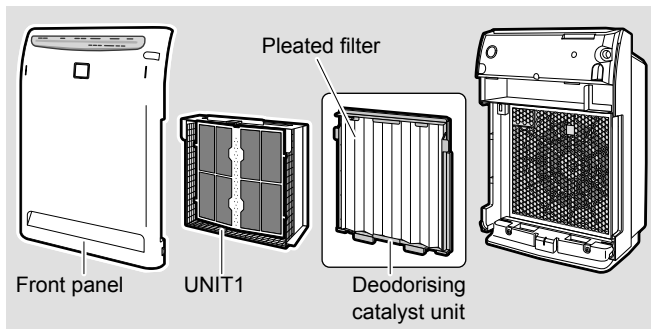

## 1 Remove the front panel and UNIT1.

▶ Page 17.

## 2 Replace the pleated filter with a new filter.

### 1) Remove the used pleated filter.

- Release the pleated filter from the projections (5 each on the right and left) of the deodorising catalyst unit (front side).

### 2) Take out a new pleated filter from the filter container and then attach it to the deodorising catalyst unit.

- Fit the holes (5 each on the right and left) of the pleated filter onto the tabs on the right and left of the deodorising catalyst unit.
- Insert the pleated filter underneath the tabs (4 locations at the top and bottom) of the deodorising catalyst unit.

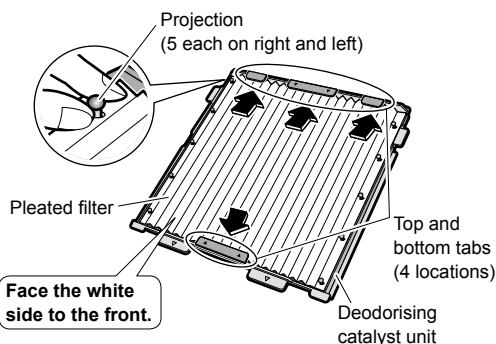

## 3 Attach UNIT1 and the front panel.

▶ Page 17.

## 4 Connect the power plug.

## 5 Press the filter reset button on the upper part of the front panel for 5 seconds.

(The filter lamp goes off with a short beep sound.)

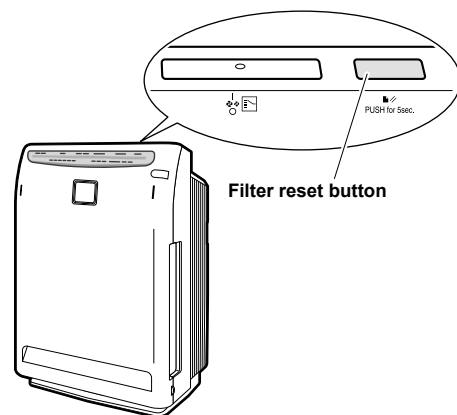

- Even if the pleated filter is replaced, the filter lamp does not go off unless you press the filter reset button for 5 seconds.

### NOTE

- Order the pleated filter for replacement from your dealer.
- Replace the pleated filter when the filter lamp lights up or blinks even if the filter looks clean. The amount of visible dirt does not represent the capacity of the filter.
- The replacement interval for the pleated filter varies according to how the unit is used and where it is located. The filter lamp lights up after about 2 years if the unit is used every day in a house where 10 cigarettes per day are smoked. (The replacement interval shortens when the unit is used where the air is particularly dirty.)
- When you have replaced the pleated filter before the filter lamp lights up because of visible dirt or generation of odour, press the filter reset button for 5 seconds.

### Options

### ATTENTION

- For replacement pleated filters contact the service shop.

Part	Model
Pleated filter 5 pcs.	KAC017A4E

- If the unit is used with dirty parts
  - Air is not cleaned.
  - Odors are not removed.
  - Unnecessary odors may be generated.
- Discard of the pleated filters as noncombustible waste.

### ■ Disposal requirements

Your product and the batteries supplied with the controller are marked with this symbol. This symbol means that electrical and electronic products and batteries shall not be mixed with unsorted household waste.

For batteries, a chemical symbol can be printed beneath the symbol. This chemical symbol means that the battery contains a heavy metal above a certain concentration.

Possible chemical symbols are:

- Pb: lead (>0.004%)
- Hg: mercury (>0.0005%)

Disposal of this product must be done in accordance with relevant local and national legislation.

Units and waste batteries must be treated at a specialized treatment facility for re-use, recycling and recovery.



By ensuring correct disposal, you will help to prevent potential negative consequences for the environment and human health. Please contact the installer or local authority for more information.

# Sensitivity Setting of the Air Quality Sensor (dust sensor)

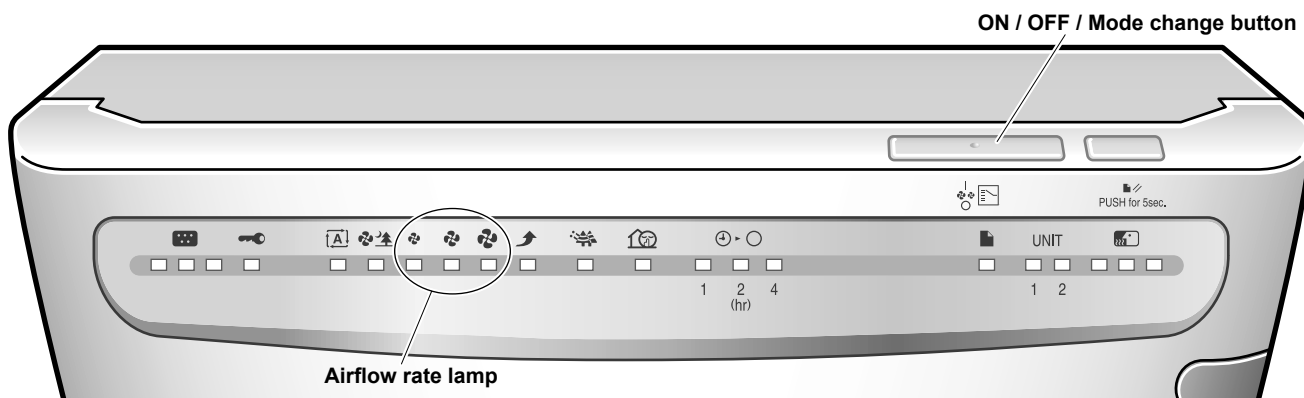
The sensitivity of the air quality sensor can be changed.

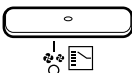

**1** Press  on the unit for 10 seconds.

**2** With  pressed, point the remote controller at the unit and press .

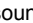
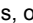
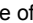
- The receiving tone sounds, one of the airflow rate lamps “ (Low)”, “ (Standard)” or “ (High)” blinks for 5 seconds, and then the lamp corresponding to the set sensitivity lights up.

**3** Change the sensitivity using  on the unit.

- Each time the button is pressed, an airflow rate lamp lights up and the sensitivity change as below.
- The sensitivity setting is indicated by the airflow rate lamps.



If the airflow rate lamps do not change, disconnect the power plug, wait at least 3 seconds, reconnect the power plug and try the operation again from the beginning.

To **raise** the sensitivity:

→ Select the “ (Low)” airflow rate lamp.

To **lower** the sensitivity:

→ Select the “ (High)” airflow rate lamp.

Airflow rate lamp	Sensitivity
 “Low”	<b>High</b>
 “Standard”	<b>Normal</b>
 “High”	<b>Low</b>

The sensor more readily reacts to dust.

Default setting

The sensor reacts less to dust.

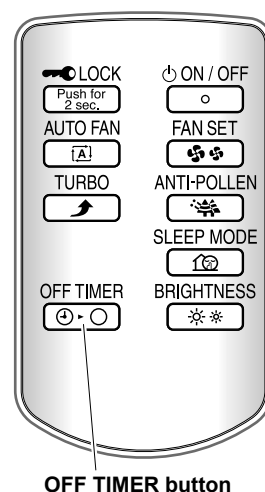

OFF TIMER button

**4** When you decide on the setting, point the remote controller at the unit and press .

- The receiving tone sounds and the lamp corresponding to the set sensitivity blinks.

**5** Remove the power plug while the set lamp is blinking, wait for 3 seconds or more, and then insert the power plug again.

## NOTE

- The sensitivity of the air quality sensor can be set whether the unit is running or stopped.
- If step **5** is not performed, the unit does not go back to the normal operating mode.
- If step **5** is performed in the middle of setting, the setting can not appropriately be completed.

# Frequently Asked Questions

Before consulting your dealer, check the following points.

**Question :** Can the deodorising catalyst unit be washed with water?  
Does the unit need to be replaced?

**Answer :** No, the deodorising catalyst unit can not be washed with water. (If the unit is washed with water, it will be deformed and become unusable.)  
When you have washed the deodorising catalyst unit by mistake, consult your dealer.  
Remove the unit from the main body, and use a vacuum cleaner to remove the dust. It is not necessary to replace the deodorising catalyst unit with a new one.  
If odour is a concern, lightly wet the surface of the deodorising catalyst unit using an atomiser, and then dry it in a shaded and well-ventilated place (about 1 day).

**Question :** The sensitivity of the air quality sensor seems low.

**Answer :** This is because the reaction time of the air quality sensor differs depending on the size of the room.  
If the unit is installed at a lower position in the room, reaction to the smoke of cigarettes or other items may be bad.  
Change the installation site of the unit or adjust the sensitivity of the air quality sensor. (▶Page 22.)

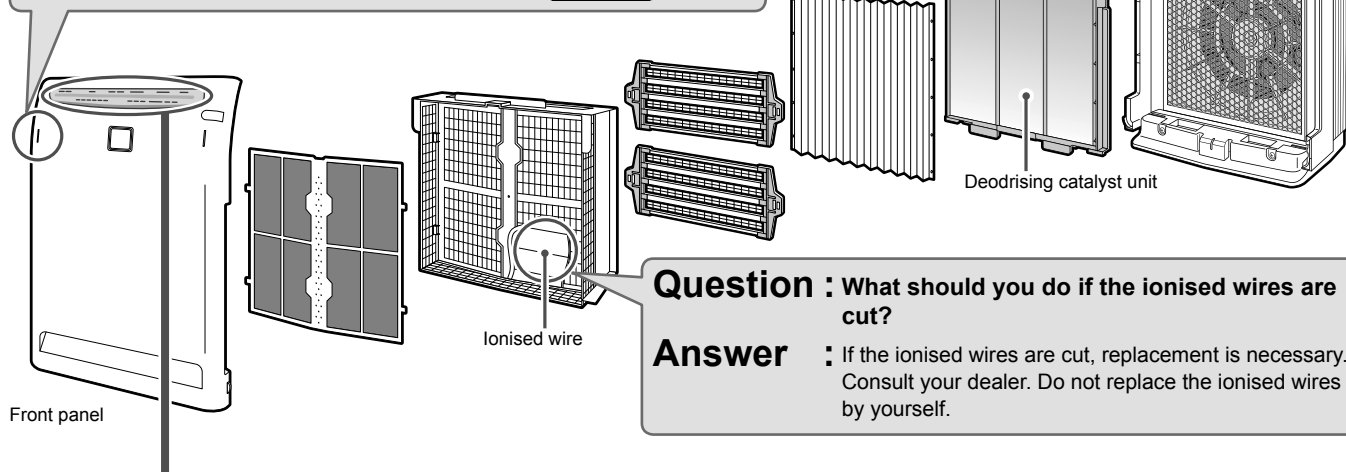

**Question :** What should you do if the ionised wires are cut?

**Answer :** If the ionised wires are cut, replacement is necessary. Consult your dealer. Do not replace the ionised wires by yourself.

## ■ “If these lamps light or blink”

### The air quality sensor lamp remains red or yellow.

This is due to the dust built up in the air quality sensor.  
Use a vacuum cleaner to remove the dust from the air inlet for the air quality sensor. (▶Page 16.)

### UNIT lamp lights up.

UNIT1: The plasma ioniser is dirty.

UNIT2: The streamer unit is dirty.

Soak and wash. (▶Page 19, 20.)

The electric dust collection and deodorising functions remarkably deteriorate because electricity supply to the ionised wires and streamer discharger stops for safety.  
Use the unit after cleaning the inside and the “UNIT1” “UNIT2” lamps go off. (There are no safety issues even if the lamps are lit.)

### The airflow rate lamps blink simultaneously.

Disconnect the power plug and remove the obstacle. Reconnect the power plug cord and turn the power on. (▶Page 25.)

### The filter lamp lights up or blinks.

Replace the pleated filter with a new one and press the filter reset button for 5 seconds. (▶Page 21.)



# Troubleshooting

Before consulting your dealer or asking for repairs, check the following points.  
If the problems still can not be solved, consult your dealer.

The unit does not operate.	
The unit does not operate even if the ON / OFF button is pressed.	<ul style="list-style-type: none"> <li>• Is the front panel correctly set? <a href="#">▶Page 10.</a></li> <li>• Are the projections on the rear of the front panel broken?               <ul style="list-style-type: none"> <li>→ Check the projections. <a href="#">▶Page 16.</a></li> <li>Consult your dealer if the projections are broken.</li> </ul> </li> <li>• Is the battery of the remote controller run down? <a href="#">▶Page 12.</a></li> </ul>
The desired results are not obtained.	
The air is not cleaned.	<ul style="list-style-type: none"> <li>• Is the unit located where the air does not reach the entire room or is something obstructing the airflow?               <ul style="list-style-type: none"> <li>→ Select an unobstructed location from where the air can reach the entire room.</li> </ul> </li> <li>• Is the prefilter, the pleated filter or UNIT1 dirty?               <ul style="list-style-type: none"> <li>→ Perform cleaning. <a href="#">▶Page 15-21.</a></li> <li>If odour of the deodorising catalyst unit is a concern, lightly wet the surface of the unit using an atomiser, and then dry it in a shaded and well-ventilated place.</li> </ul> </li> </ul>
Although there is odour, the green lamp remains lit.	<ul style="list-style-type: none"> <li>• Is a large amount of odour generated when starting operation of the unit?               <ul style="list-style-type: none"> <li>→ The odour level of the initial 1 minute is used as the standard for the sensitivity of the odour sensor. Operate the unit with an increased airflow. <a href="#">▶Page 8.</a></li> <li>Modify the standard sensitivity of the odour sensor using the following procedure.</li> <li>When the air is clean (when there is no odour), disconnect the power plug and wait for 3 or more seconds. Connect the power plug once again, and start operation.</li> </ul> </li> </ul>
Odour comes from the air outlet.	<ul style="list-style-type: none"> <li>• Is a large amount of odour generated temporarily? (i.e., many people are smoking, grilling meat, etc.)               <ul style="list-style-type: none"> <li>→ Operate the unit and the odour should gradually go away.</li> </ul> </li> <li>• Have you moved the unit from another room?               <ul style="list-style-type: none"> <li>→ The original room may have an odour.</li> <li>Operate the unit for a while.</li> </ul> </li> <li>• Are odours constantly generated in the room? (i.e., paint, new furniture, wall paper, sprays, cosmetics, chemicals, etc.)               <ul style="list-style-type: none"> <li>→ As odour that is constantly generated can not be completely removed, use the ventilation system in the room or operate the unit in a well-ventilated room for a while.</li> </ul> </li> <li>• You may smell an odour as ozone particles are generated. The amount is negligible, so it does not harm your health.</li> </ul>

# Troubleshooting

Before consulting your dealer or asking for repairs, check the following points.  
If the problems still can not be solved, consult your dealer.

A sound is heard.	
<b>A crackling or buzzing sound is heard during operation.</b>	<ul style="list-style-type: none"> <li>• <b>Are UNIT1 and UNIT2 correctly set?</b> → Insert UNIT1 until it clicks. Insert UNIT2 completely to the end. <a href="#">▶Page 17-20.</a></li> <li>• <b>Is dust adhered to UNIT1 and UNIT2?</b> <a href="#">▶Page 19, 20.</a></li> </ul>
<b>A fizzing sound is heard during operation.</b>	<ul style="list-style-type: none"> <li>• UNIT2 makes a hissing sound caused by the streamer discharge during operation. Depending on the usage conditions, the sound becomes lower or the sound quality may change, but this does not indicate any problem with operation. If the sound persists, change the installation site of the unit.</li> </ul>

The lamp lights up or blinks.	
<ul style="list-style-type: none"> <li>■ The airflow rate lamps blink simultaneously.</li> <li>■ The unit does not blow air.</li> </ul>	<ul style="list-style-type: none"> <li>• <b>Is there any obstacle in the air outlet?</b> → Disconnect the power plug and remove the obstacle. Reconnect the power plug and turn the power on. If the present condition does not change or you can not remove the obstacle, consult your dealer.</li> </ul>
<b>The “UNIT1” lamp or “UNIT2” lamp does not go off or light up again even after cleaning UNIT1 or UNIT2.</b>	<ul style="list-style-type: none"> <li>• <b>Are UNIT1 and UNIT2 set correctly?</b> → Insert UNIT1 until it clicks. Insert UNIT2 completely to the end. <a href="#">▶Page 17-20.</a></li> <li>• <b>Are water drops, detergent, or bits of fibre left in UNIT1 and UNIT2 after cleaning?</b> → After cleaning, wash UNIT1 and UNIT2 well so as not to leave detergent or bits of fibre, and completely dry them.</li> <li>• <b>Are the ionised wires cut?</b> → Check the ionised wires. Consult your dealer for replacement with new ones.</li> </ul>
<b>The filter lamp does not go off, although the pleated filter is replaced.</b>	<ul style="list-style-type: none"> <li>• <b>Did you press the filter reset button for 5 seconds?</b> → Even if the pleated filter is replaced, unless you press the filter reset button for 5 seconds, the filter lamp does not go off. <a href="#">▶Page 21.</a></li> </ul>

Other	
<b>There is a burn mark on the metal part of UNIT2.</b>	<ul style="list-style-type: none"> <li>• This is a mark made by the streamer discharge and is not abnormal.</li> </ul>
<b>The TV picture is distorted.</b>	<ul style="list-style-type: none"> <li>• <b>Is a TV or radio installed within 2m of the unit or is an indoor antenna used close to the unit?</b></li> <li>• <b>Is the power supply cord or the antenna of the TV or radio close to the unit?</b> → Move the unit as far away from TVs, radios and antennas as possible.</li> </ul>



CE - DECLARATION-OF-CONFORMITY  
CE - KONFORMITÄTSERKLÄRUNG  
CE - DECLARATION-DE-CONFORMITE  
CE - CONFORMITEITSVERKLARING

CE - DECLARACION-DE-CONFORMIDAD  
CE - DICHIARAZIONE-DI-CONFORMITA  
CE - ΔΗΛΩΣΗ ΣΥΜΜΟΡΦΩΣΗΣ

CE - DECLARAÇÃO-DE-CONFORMIDADE  
CE - ЗАЯВЛЕНИЕ-О-СООТВЕТСТВИИ  
CE - OPFYLDSESRKLÆRING  
CE - FÖRSÄKRAN-OM-ÖVERENSTÄMMELSE

CE - ERKLÆRING OM-SAMSVAR  
CE - ILMOITUS-YHDENMUKAISUUDESTA  
CE - PROHLÁŠENÍ O-SHODĚ

CE - IZJAVA-O-USKLAĐENOSTI  
CE - MEGFELELŐSÉGI-NYILATKOZAT  
CE - DEKLARACJA-ZGODNOŚCI  
CE - DECLARATION-DE-CONFORMITE

CE - IZJAVA O SKLADNOSTI  
CE - VASTAVUSDEKLARATSIOON  
CE - ДЕКЛАРАЦИЯ-ЗА-СЪОТВЕТСТВИЕ

CE - ATĪKTIĒS-DEKLARĀCIJA  
CE - ATBILSTĪBAS-DEKLARĀCIJA  
CE - VYHLÁSENIE-ZHODY

**DAIKIN INDUSTRIES, LTD.**

01 declares under its sole responsibility that the air purifier models to which this declaration relates:

02 erklaart op seine alleinige Verantwortung dass die Modelle der Luftreinigungsmittel für die diese Erklärung bestimmt ist:

03 déclare sous sa seule responsabilité que les modèles de purificateurs d'air visés par la présente déclaration:

04 erklärt hiermit auf eigen exclusive verantwortlichkeit dass die typen luftreinigers waaren diese verklärung betrefkend heifit:

05 declara bajo su única responsabilidad que los modelos de purificador de aire a los cuales esta declaración se refiere:

06 dichiara sotto sua sola responsabilità che i modelli di depuratore di aria a cui il riferimento questa dichiarazione:

07 δηλώνει με αποκλειστική ευθύνη ότι τα προϊόντα των αναφερόμενων καθαριστών αέρα από ονόμα αφετηρία ή τοποθεσία οφείλουν:

08 declara sub sa exclusivă responsabilitate că acești modele de purificatori de aer a căror nume este această declarație se referă:

**MC70LVM**

01 are in conformity with the following standard(s) or other normative document(s), provided that these are used in accordance with our instructions:

02 der/den folgenden Norm(en) oder einem anderen Normdokument entsprechend; unter der Voraussetzung, dass sie gemäß unseren Anweisungen eingesetzt werden:

03 sont conformes à la/aux norme(s) ou autre(s) document(s) normal(s) pour autant qu'ils soient utilisés conformément à nos instructions:

04 conform de volgende norm(en) of één of meer andere bindende documenten zijn, op voorwaarde dat ze worden gebruikt overeenkomstig onze instructies:

05 están en conformidad con la(s) siguiente(s) norma(s) u otro(s) documento(s) normal(es), siempre que sean utilizados de acuerdo con nuestras instrucciones:

06 sono conformi al/i) seguente(s) standard(s) o altro/i) documento/i) a carattere normativo, a patto che vengano usati in conformità alle nostre istruzioni:

07 είναι σύμφωνα με το(α) ακόλουθ(ή) πρότυπο(α) ή άλλο(α) έγγραφο(α) κανονισμ(α)ν, υπό την προϋπόθεση ότι χρησιμοποιούνται σύμφωνα με τις οδηγίες μας:

EN60335-2-65

01 following the provisions of:	19 du ustavejavnih določb;
02 enačba den. konvizičnega:	20 ustavnih navedb;
03 conformément aux stipulations de:	21 spadalcaj krajšnje ka:
04 overeenkomstig de bepalingen van:	22 akcijns nastatj, pakemak:
05 siglendo las desposiciones de:	23 akcijns nastatj, kas notekas:
06 secondo le prescrizioni per:	24 održavajevj ustanovajevj:
07 sur le type des barèmes tax:	16 kóvél ajaz:
08 de accord com o plejovato em:	17 ajzójne z postaravlenajm Drekavajevj:
09 в соответствии с положениями:	18 in uma postaravlenaj:

01	Note *	as set out in <> and judged positively by <> according to the Certificate <>.	delibado no <> e julgado positivamente por <> segundo li Certificate <>.
02	Hinweis *	wie in der <> aufgeführt und von <> positiv beurteilt gemäß Zertifikat <>.	omlak nadožgotilo <> na <> i pozitivno beđadilo tomo <> oduvao je to fluoromimio <>.
03	Remarque *	tel que défini dans <> et évalué positivement par <> conformément au Certificat <>.	talo como estabelecido em <> e com o parecer positivo de <> de acordo com o Certificado <>.
04	Bemerk *	zodis vermeld in <> in positief beoordeeld door <> overeenkomstig Certificat <>.	kak ukazano je <> iz odgovarajućih s podporučnim rešenjem <> sopotko Svidenostu <>.
05	Nota *	como se establece en <> y es valorado positivamente por <> de acuerdo con el Certificado <>.	som anitoti <> og pozitivni nuderati at <> i henhold til Certificat <>.
06	Nota *		
07	Erklärung *		
08	Nota *		
09	Примечание *		
10	Bemerk *		

CE - DECLARAÇÃO-D  
CE - ЗАЯВЛЕНИЕ-О-О  
CE - OPFYDELSESE

CE - ERKLÆRING OM CE - ILMOITUS-YHTEY- CE - PROHLÁŠENÍ	CE - CONFORMIDADE CE - ILMOITUS-YHTEY- CE - PROHLÁŠENÍ
--	--

SAMSVAR  
MUKAİSUUDESTA  
RHODÉ  
CE - IZJAVA-O-UŠK  
CE - MEGFELELOŠ  
CE - DEKLARACJA  
CE - DECLARATIE

**CE - IZJAVA O SKLADNOSTI  
CE - VASTAVUSDBERUNG  
CE - ДЕКЛАРАЦИЯ**

CE - ATIKTIES-  
CE - ATBILSTĪBAS  
CE - VYHLÁSENIE

CE - ATĪKTIĒS-DEKLARĀCIJA  
CE - ATBILSTĪBAS-DEKLARĀCIJA  
CE - VYHLÁŠENIE-ZHODY

[illegible]

08 estão em conformidade com as seguinte(s) norma(s) ou outro(s) documento(s) normativo(s), desde que estes sejam utilizados de acordo com as suas instruções:

09 соответствуют следующим стандартам или другим нормативным документам, при условии их использования согласно нашим инструкциям:

10 overholder følgende standard(er) eller andet/andre retningsvende dokument(er), forudsat at disse anvendes i henhold til vore instruks:

11 respektive utrustning är utförd i överensstämmelse med och följer följande standard(er) eller andra normgivande dokument, under förutsättning att användning sker i överensstämmelse med våra instruktioner:

12 respektive ustrý er í óvæðsstæmmelse með fölgjenda standard(er) eller öðrum normgjvndum dokumentum, undir forðsetningu að þessir brúkarar nota vörur okkar samkvæmt þessum leiðsögum:

13 vastavetel seuraveten standardien ja muiden ohjeellisten dokumenttien vaatimuksia edellyttäen, että niitä käytetään ohjeidenmukaisesti:

14 za předpokladu, že jsou využívány souladu s našimi pokyny, odpovídaj následujícím normám nebo normativním dokumentům:

15 u skladu sa slediacim standardom(ami) ili drugim normativnim dokumentom(ima), uz uvjet da se oni koriste u skladu s našim uputama:

[illegible]

**Shinri Sada**  
**Manager Qu**

Manager Quality Control Department

2011.03.04

**DAIKIN INDUSTRIES, LTD.**

Umeda Center Bldg., 2-4-12, Nakazaki-Nishi,

Kita-ku, Osaka, 530-8323 Japan

<A>	DAIKIN.TCF.018 E3/10-2010
<B>	KEMA Quality B.V.
<C>	82726-KRQ/EMC98-4545

10. Driedkiv, med senere andringer.
11. Driedkiv, med foretagne andringer.
12. Driedkiv, med foretagne andringer.
13. Driedkiv, med foretagne andringer.
14. Driedkiv, med foretagne andringer.
15. Smerica, kako je zmijenjeno.
16. Iranyeliyek is módosításk rendelkezését.
17. z późniejszymi poprawkami.
18. Driedkiv, cu amendamentele respective.

<A>	DAIKIN.TCF.018 E3/10-2010
<B>	KFMA Quality B.V.

**DAIKIN INDUSTRIES, LTD.**  
Umeda Center Bldg., 2-4-12, Nakazaki-Nishi,  
Kita-ku, Osaka, 530-8323 Japan

**3SB64467-2A**

**DAIKIN INDUSTRIES, LTD.**

Head office:

Umeda Center Bldg., 2-4-12, Nakazaki-Nishi,  
Kita-ku, Osaka, 530-8323 Japan

Tokyo office:

JR Shinagawa East Bldg., 2-18-1, Konan,  
Minato-ku, Tokyo, 108-0075 Japan  
[http://www.daikin.com/global\\_ac/](http://www.daikin.com/global_ac/)

**DAIKIN EUROPE NV**

Zandvoordestraat 300, B-8400 Oostende, Belgium



Two-dimensional bar code is a code  
for manufacturing.

3P276413-1B M10B193B (1105) HT